

TEXAS COLLEGE OF
OSTEOPATHIC MEDICINE

89~90
CATALOG

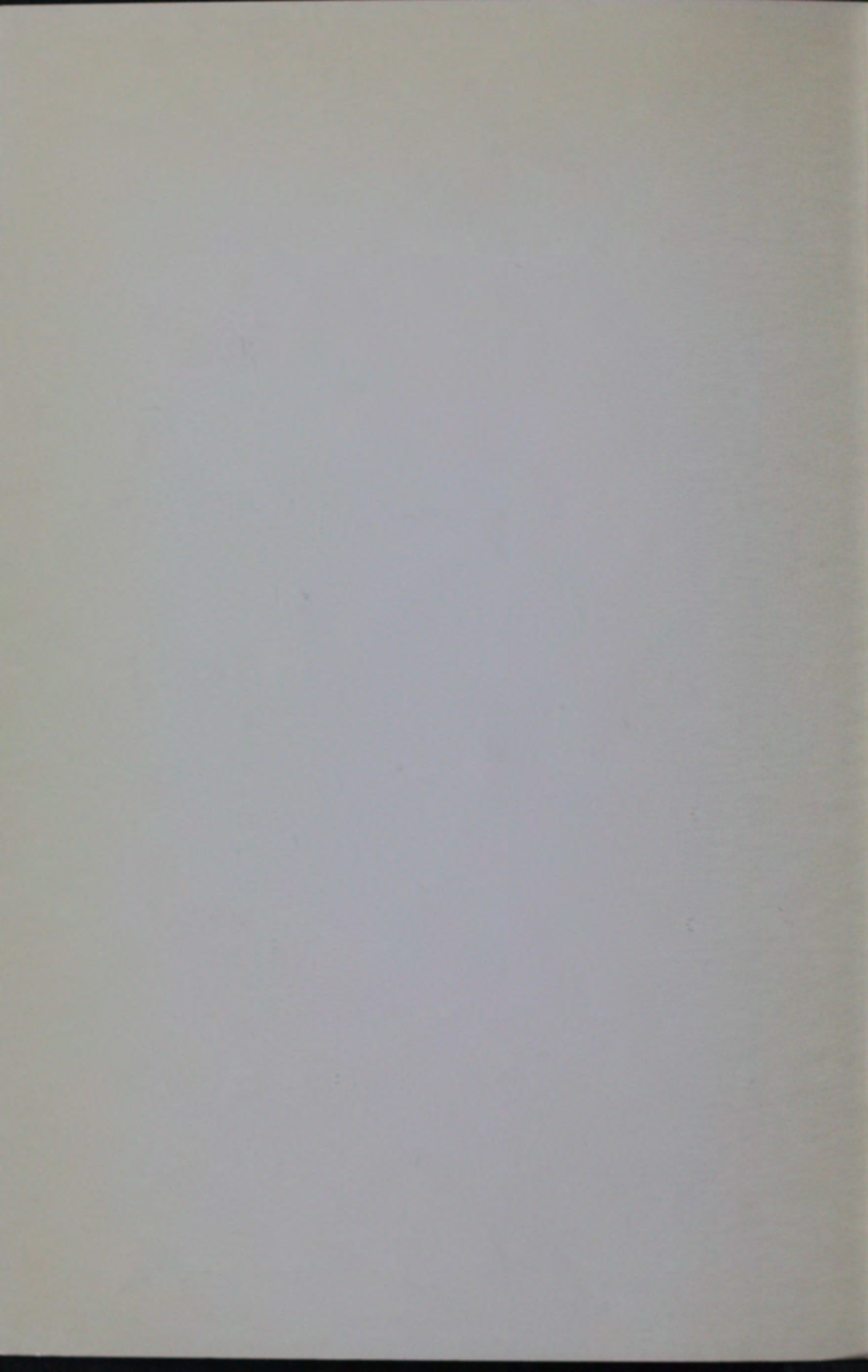



TEXAS COLLEGE OF
OSTEOPATHIC MEDICINE

89~90
CATALOG

Accreditation

Texas College of Osteopathic Medicine is accredited by the Bureau of Professional Education of the American Osteopathic Association. The Bureau is recognized by the U.S. Office of Education and the Council on Post-Secondary Accreditation as the official accrediting agency for osteopathic medicine. TCOM is approved by the Coordinating Board, Texas College and University System, and by the Texas State Board of Medical Examiners. TCOM maintains membership in the American Association of Colleges of Osteopathic Medicine and The Association of Academic Health Centers.

It is the policy of Texas College of Osteopathic Medicine not to discriminate on the basis of sex, color, religion, age, national origin, handicap, disabled veteran status or Vietnam Era status in its educational programs, activities, admissions or employment policies.

Texas College of Osteopathic Medicine is under the direction of the University of North Texas Board of Regents.

*The Osteopathic Concept**

Osteopathic medicine is a philosophy of health care and a distinctive art, supported by expanding scientific knowledge. Its philosophy embraces the concept of the unity of the living organism's structure (anatomy) and function (physiology). Its art is the application of the philosophy in the practice of medicine and surgery in all its branches and specialties. Its science includes the behavioral, chemical, physical, spiritual and biological knowledge related to the establishment and maintenance of health as well as the prevention and alleviation of disease. Osteopathic concepts emphasize the following principles:

1. The human body is a unit in which structure, function, mind and spirit are mutually and reciprocally interdependent.
2. The body, through a complex equilibrical system, tends to be self-regulatory and self-healing in the face of disease processes.
3. Adequate function of body systems depends upon the unimpeded circulatory mechanisms, nerve impulses and neutrophic influences.
4. A rational treatment regimen is based on this philosophy and these principles.

** Statement adopted by the Department of Osteopathic Philosophy, Principles and Practice, February 1978, Texas College of Osteopathic Medicine. The Osteopathic Concept definition was updated in 1979 by the Educational Council on Osteopathic Principles.*

Accreditation

Texas College of Osteopathic Medicine is accredited by the Bureau of Professional Education of the American Osteopathic Association. The Bureau is recognized by the U.S. Office of Education and the Council on Post-Secondary Accreditation as the official accrediting agency for osteopathic medicine. TCOM is approved by the Coordinating Board, Texas College and University System, and by the Texas State Board of Medical Examiners. TCOM maintains membership in the American Association of Colleges of Osteopathic Medicine and The Association of Academic Health Centers.

It is the policy of Texas College of Osteopathic Medicine not to discriminate on the basis of sex, color, religion, age, national origin, handicap, disabled veteran status or Vietnam Era status in its educational programs, activities, admissions or employment policies.

Texas College of Osteopathic Medicine is under the direction of the University of North Texas Board of Regents.

The Osteopathic Oath

I do hereby affirm my loyalty to the profession I am about to enter. I will be mindful always of my great responsibility to preserve the health and the life of my patients, to retain their confidence and respect both as a physician and a friend who will guard their secrets with scrupulous honor and fidelity, to perform faithfully my professional duties, to employ only those recognized methods of treatment consistent with good judgment and with my skill and ability, keeping in mind always nature's laws and the body's inherent capacity for recovery.

I will be ever vigilant in aiding the general welfare of the community, sustaining its laws and institutions, not engaging in those practices which will in any way bring shame or discredit upon myself or my profession. I will give no drugs for deadly purposes to any person, though it be asked of me.

I will endeavor to work in accord with my colleagues in a spirit of progressive cooperation, and never by word or by act cast imputations upon them or their rightful practices.

I will look with respect and esteem upon all those who have taught me my art. To my college I will be loyal and strive always for its best interests and for the interests of the students who will come after me. I will ever be alert to further the application of basic biologic truths to the healing arts and to develop the principles of osteopathic medicine as taught by my profession.

In the presence of this gathering I bind myself to this oath.

ONE

The College p. 9

TWO

Admissions and Financial Aid p. 17

THREE

Scholastic Regulations p. 25

FOUR

Curriculum p. 37

FIVE

Student Affairs p. 63

SIX

The Faculty p. 67

INDEX

ADMINISTRATION

University of North Texas/Texas College of Osteopathic Medicine

Board of Regents

R. L. Crawford Jr., Lewisville

Jerry Farrington, Dallas

J. Jack Hays, Dallas

Joe Kirven, Dallas

Lucille G. Murchison, Dallas

Billie Parker, Fort Worth

E. Bruce Street Sr., Graham

Topsy Wright, Grand Prairie

University of North Texas/Texas College of Osteopathic Medicine

Chancellor

Alfred F. Hurley, Ph.D.

Texas College of Osteopathic Medicine

David M. Richards, D.O., F.A.C.G.P., President

Mike Ferguson Jr., C.P.A., Vice President for Fiscal and Administrative Affairs

T. Eugene Zachary, D.O., F.A.C.G.P., Vice President for Academic Affairs and Dean

J. Warren Anderson, Ed.D., Executive Assistant to the President

and Associate Dean for Medical Education

Edward E. Elko, Ph.D., Interim Associate Dean for Student Affairs

Ben G. Harris, Ph.D., Associate Dean for Research

Carl E. Jones, Ph.D., Associate Dean for Basic Sciences

John R. Peckham, D.O., Associate Dean for General Medicine

Paul A. Stern, D.O., Associate Dean for Specialty Medicine

William R. Jenkins, D.O., Associate Dean for Graduate Medical Education

and Continuing Medical Education

Richard J. Sinclair, Ph.D., Acting Assistant Dean for Admissions

Ken Coffelt, Assistant Vice President for Administrative Affairs

William T. Foxworth, Assistant Vice President for Fiscal Affairs

Dan Jensen, Director for External Affairs

Carole A. Tayman, Executive Director for Development

TCOM Administrative Staff

Don Beeson, Police Chief
Betty Belton, Registrar
Bobby R. Carter, Director of Library Services
Pat Casey, Budget Director
Tom Cox, Director of Biomedical Communications
W. Rand Horsman, Director of Personnel
Mary McAnally, Director of Purchasing
Greg McQueen, Assistant to the Vice President for Academic Affairs and Dean
Steve Russell, Director of Medical Services, Research and Development Plan
Harry J. Marek, Director of Physical Plant
Albert Srubar Jr., Controller
Glenda A. Tucker, Director of Financial Aid

TCOM Advisory Council

Jay E. Sandelin, Chairman, Fort Worth
Minerva Hobart "Tiny" Batts, Fort Worth
Maxie Davie, Fort Worth
Carl E. Everett, D.O., Fort Worth
Tom Hanstrom, Fort Worth
Eddy Herrera, Fort Worth
Richard C. Hochberger, D.O., Fort Worth
Erma C. Johnson, Fort Worth
Robert M. Lansford, Fort Worth
Joseph Montgomery-Davis, D.O., Raymondville
Lewis T. "Pat" Patterson, Laie, Hawaii
Robert L. Peters, D.O., F.A.C.G.P., Round Rock
Wayne Stockseth, Corpus Christi
E. Bruce Street Sr., Graham
Carson R. Thompson, Fort Worth
Harry K. Werst, Fort Worth

Information is current as of July 1, 1989

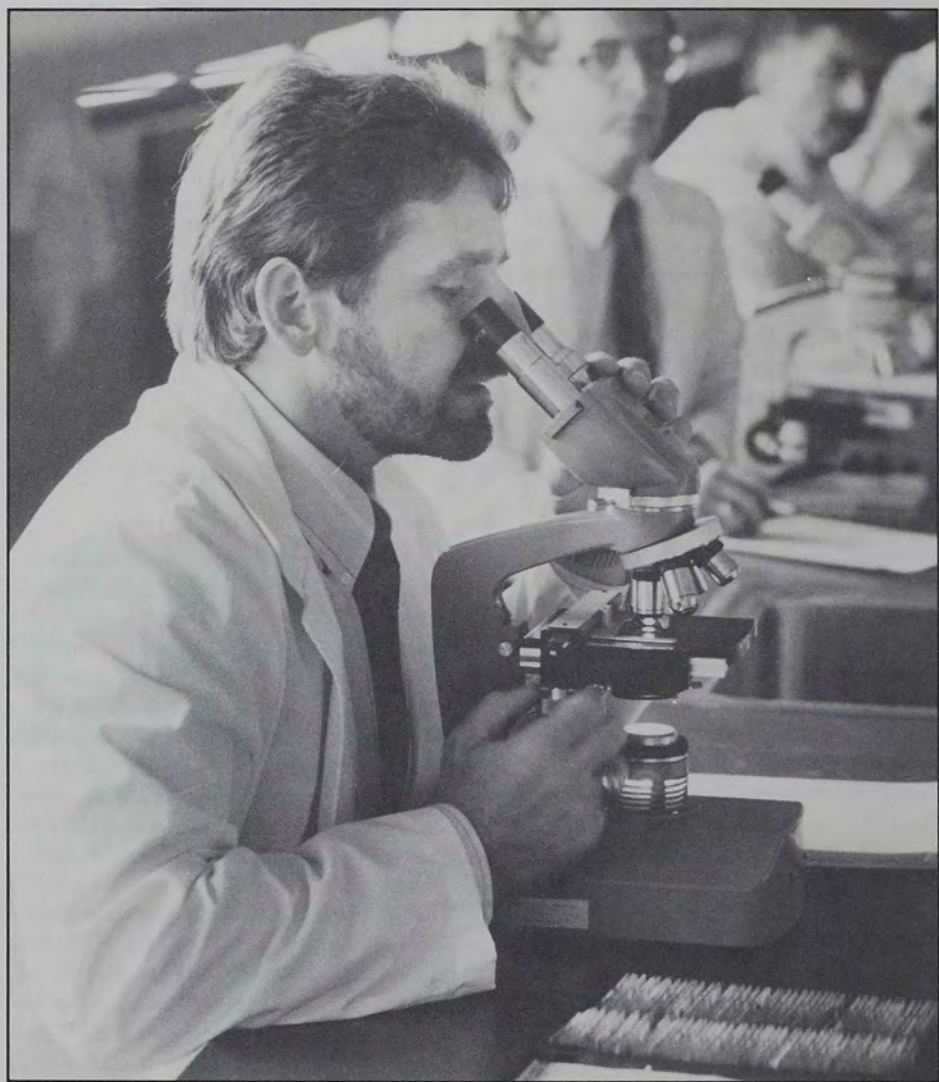

1989-1990 CALENDAR

Fall Semester 1989

June 23

Registration for Year III students

June 26

First day of classes for Year III students

June 30

Last day to register for Year III classes

July 4

Independence Day Holiday

August 7-10

Orientation for Year I students

August 11

Registration for Year I and Year II students

August 14

First day of classes for Year I and Year II students

August 18

Last day to register for Year I and Year II classes

September 4

Labor Day holiday

September 8

Last day to withdraw with partial refund of tuition

October 19-20

Administration of Parts I and II, National Board of Examiners for Osteopathic Physicians and Surgeons Inc.

October 20

Last day of classes for Year III students

October 25

Fall semester grades for Year III students due in Office of Registrar

October 30

Clinical clerkships begin for Year III students

November 23-24

Thanksgiving holiday

December 15

Last day of classes for Year II students

December 22

Fall semester grade reports for Year II students due in Office of Registrar

December 25-January 1

Faculty, staff and student holiday

Spring Semester 1990

January 2

*Classes begin for Year II students
Fall classes resume for Year I students*

January 19

Last day of fall semester classes for Year I students

January 22

*Comprehensive examination for seniors
Spring classes begin for Year I students*

January 29

Fall semester grades for Year I students due in Office of Registrar

February 19-20, 22-23

Administration of Part III, National Board of Examiners for Osteopathic Physicians and Surgeons Inc.

March 15-16

Administration of Part II, National Board of Examiners for Osteopathic Physicians and Surgeons Inc.

March 19-23

Spring break for Year I and Year II students

May 25

Last day of classes for Year IV students

May 28

Memorial Day holiday

June 1

*Last day of classes for Year I and Year II students
Senior Awards Banquet*

June 2

Commencement

June 7-8

Administration of Part I, National Board of Examiners for Osteopathic Physicians and Surgeons Inc.

June 8

Spring semester grade reports for Year I and Year II students due in Office of Registrar

ONE

The College

TWO

THREE

FOUR

FIVE

SIX

INDEX

Mission

Growth and Facilities

Our Community

Clinics and Teaching Hospitals

Support Services



MISSION

Texas College of Osteopathic Medicine is committed to a curriculum based on the promotion of health. In 1980 the college adopted a statement of educational goals that outlined a plan for changing the emphasis in education of future physicians from "defensive" treatment of disease to "offensive" promotion of health. While recognizing its obligation to train student doctors to attack existing disease in the traditional manner, the college concentrates equally on preparing future physicians to promote health and wellness among their patients.

Such an educational program allows TCOM to serve the health needs of

several populations within its reach as it not only advances traditional medical knowledge but also explores new directions in health care.

GROWTH AND FACILITIES

Texas College of Osteopathic Medicine was conceived in 1961 by a group of Texas D.O.s who saw a need in the state for a college of medicine that emphasized primary health care. In 1966 a charter was granted to TCOM, and in 1970 the first 20 students began their studies in temporary quarters at Fort Worth Osteopathic Hospital. The college expanded and moved to larger, but still temporary, quarters in August

1971. As it grew, TCOM contracted with North Texas State University in Denton (now the University of North Texas) for the teaching of the basic sciences. In 1975, by legislative act, TCOM became a state institution under the direction of NTSU's Board of Regents.

The first step in the campus master plan was completed in 1978 when TCOM opened the eight-story Medical Education Building 1, designed to accommodate clinical science departments, clinics and administrative offices. Medical Education Building 2, a five-story facility housing basic science departments, laboratories and classrooms, opened in the fall of 1982. The four-story Medical Education Building 3, which opened in early 1987, contains the Health Sciences Library, biomedical communications departments and computing facilities. Also on campus are several clinics, the Activities Center and Campus Police. Adjacent to campus is Fort Worth Osteopathic Medical Center, TCOM's primary teaching hospital.

OUR COMMUNITY

TCOM's campus is a prominent, 16-acre medical care complex in the heart of Fort Worth, and is part of the city's popular cultural district. Fort Worth is the seat of Tarrant County, which has a population of more than one million. There are 29 colleges and universities within 50 miles of Fort Worth, with a total enrollment of more than 165,000. Often called Cowtown because of its important role in the history of the cattle industry, Fort Worth has maintained the relaxed pace of Western living and hospitality even as it has been a major contributor to the industrial, cultural and educational advancement of North Texas. Fort Worth was nationally recognized for its character and livability in January 1989 when Newsweek magazine named it one of the 10 top midsized cities in the United States.

CLINICS AND TEACHING HOSPITALS

TCOM operates six general and family clinics and 13 specialty clinics. Student doctors in these clinics are directly supervised by fully licensed osteopathic physicians trained in the appropriate areas.

The following clinics are under the administration of the Department of General and Family Practice:

Carswell Air Force Base Champus Clinic

Carswell A.F.B., Building 3109,
Clinic A
Fort Worth, Texas
Stephen F. Urban, D.O., Director

Central Family Practice Clinic

3500 Camp Bowie Boulevard
Fort Worth, Texas
Constance Jenkins, D.O., Director

Godley Family Practice Clinic*

117 Main Street
Godley, Texas
William H. Clark Jr., D.O., Director

Justin Family Practice Clinic*

310 E. Second Street
Justin, Texas
Gerald P. Flanagan, D.O., Director

Northside Family Practice Clinic

1851 Harrington
Fort Worth, Texas
Frank Falbey, D.O., Director

Southside Family Practice Clinic

1025 S. Jennings
Fort Worth, Texas
Donald Peterson, D.O.
John Carter, D.O.
Co-directors

* Rural clinic

Specialty clinics operated by other TCOM academic departments include:

Center for Osteopathic Research and Education

Health and Human Fitness Clinic

Hyperbaric Oxygen Treatment Center

Internal Medicine Clinic

Internal Medicine Nephrology Division

Obstetrical and Gynecological Consultants

Osteopathic Manipulative Medicine Clinic

Psychiatry and Human Behavior Clinic

Psychiatry and Human Behavior at Carswell

Public Health and Community Medicine Clinic

Rehabilitation/Sports Medicine Clinic

Surgical Associates of Fort Worth

Westside Pediatric Consultants

Eleven Texas hospitals serve as teaching hospitals for TCOM and provide some 2,000 patient-care beds. They are:

Fort Worth Osteopathic Medical Center

Fort Worth, Texas

Gary Earp, D.O.,

Director of Medical Education

U.S. Air Force Regional Hospital

Carswell Air Force Base

Fort Worth, Texas

Col. Thomas Kramer, M.D.,

Director of Medical Education

Corpus Christi Osteopathic Hospital

Corpus Christi, Texas

Mel S. Eliades, D.O.

Director of Clinical Clerk Education

Dallas Family Hospital

Dallas, Texas

P.T. Sullivan, D.O.,

Director of Medical Education

Dallas/Fort Worth Medical Center -- Grand Prairie

Grand Prairie, Texas

Otto Puempel, D.O.,

Director of Medical Education

Dallas Memorial Hospital

Dallas, Texas

John Wilson, D.O.,

Director of Clinical Clerk Education

Darnall Army Community Hospital

Fort Hood, Texas

Northeast Community Hospital

Bedford, Texas

Russell Martz, D.O.,

Director of Medical Education

Psychiatric Institute of Fort Worth

Fort Worth, Texas

The University of Texas Health Center at Tyler

Tyler, Texas

Wilber G. Avery, M.D.,

Director of Medical Education

William Beaumont Army Medical Center

El Paso, Texas

SUPPORT SERVICES

Medical Education

The Office of Medical Education exists primarily to organize and provide certain educational support services throughout TCOM. The office supports curriculum and instructional activities within the academic program. The general goals are to stimulate concern for sound educational practices and to assist in implementing those practices that are endorsed by the administration and faculty.

Specific activities include curriculum support and implementation, instructional design and development, audio-visual production and distribution, library and learning facilities operation and faculty development.

Divisions of the Office of Medical Education include Biomedical Communications and the Health Sciences Library.

Health Sciences Library

TCOM's Health Sciences Library supports the education, patient-care, research and community-service functions of the college by meeting the information needs of faculty, students, staff and the local health sciences community.

The library provides large collections of print and non-print materials in the basic and clinical health sciences. Library collections include more than 99,000 bound volumes and more than 2,200 biomedical journal titles.

The library's Special Collections includes more than 1,600 volumes, with primary emphasis on osteopathic medicine and 19th century American medicine. Also included is an oral history collection of recorded interviews with individuals who have either witnessed or participated in the development of TCOM and the osteopathic profession in Texas.

The Learning Resource Center houses an audio-visual software collection of some 3,700 programs, computer software and 90 anatomic models. The center also provides access to more than 100 medical computer-assisted instructional programs through Ohio State University. Rooms and carrels are equipped with video playback and slide-tape equipment for both large and small group viewing.

The LRC houses Apple II+ and Tandy 1200 HD (IBM compatible) microcomputers. In addition, a new microcomputer instructional lab, used in the computer-literacy program, contains 12

personal computers, 10 Macintosh IIs, an instructor station and a variety of printers.

The library provides access through interlibrary loan to the collections of 25 members of the Dallas-Tarrant County Consortium of Health Science Libraries, to the collections of 15 other medical school libraries that are members of the South Central Academic Medical Libraries Consortium, and to the services and resources of the five-state Regional Medical Library Program (including Texas, Arkansas, Louisiana, Oklahoma and New Mexico) and its national counterpart, the National Library of Medicine in Bethesda, Md.

Traditional reference services as well as the latest in online information services are provided to TCOM faculty, staff and students through MEDLINE and more than 200 other databases and files.

Library services, including free document delivery, are provided for third- and fourth-year students on rotation in local clinics and hospitals through the Extramural Services Program. Ten rotation sites are equipped with telefacsimile units that give student/doctors access to the Health Sciences Library's computer searches and/or articles within minutes.

The library moved into Medical Education Building 3 in December 1986. The 110,000-square-foot building was funded by state appropriations of \$10.8 million to house the library, biomedical communications and campus computer facilities. The library occupies about 65,000 square feet on the top three floors of the four-story facility, and can accommodate more than 200,000 volumes and more than 500 users.

Biomedical Communications

The Biomedical Communications Department is an educational-service unit that supports development and implementation of the college curriculum.

Composed of medical arts/photography, audio-visual/television and electronic engineering, the department's primary functions are the design and production of various forms of learning materials and the repair of equipment used by faculty and students.

Videotaping of procedures, patients or lectures as well as production of specialized educational or promotional programs is available both in the studio and on location. Classroom playback of instructional videos, set-up of audio-visual equipment for classroom use, student equipment check-out, maintenance of biomedical and electronic equipment and audio-visual systems design are additional services offered by the department.

Medical arts personnel create charts, graphs, illustrations, posters, brochures, newsletters and magazines for the various educational, research and community-service endeavors of the college. Medical photographers provide the prints and slides to complete these instructional and promotional materials as well as on-site photography of patients, procedures and important college events.

Computing and Telecommunication Services

The Computing and Telecommunication Services Department serves the TCOM community in five major areas: Evaluation Services, Computer Systems Analysis and Programming Services, Computer Network Services, Computer User Support Services and Telecommunication Services.

Evaluation Services provides scoring of didactic and clerkship examinations, the evaluation of courses and instructors, the administration of the Senior Comprehensive Examination and the prediction of FLEX scores for the senior class. This unit also provides statistical consultation, analysis, and reporting for a variety of academic and

administrative applications.

Computer Systems Analysis and Programming Services develops systems and programs for fiscal and academic administrative areas of TCOM. It also designs and develops systems that integrate management information from units, both internal and external to the college, into a common data base and generates management reports of various types.

Computer Network Services is responsible for the design, installation and maintenance of academic and administrative local-area networks (LANs) on campus. Computer users connected to a LAN can access a variety of software as well as exchange data and electronic mail with users in other locations on campus. A microwave connection is maintained to computers at the University of North Texas.

Computer User Support Services provides data entry, report generation and printing services to several administrative departments. Consulting and user assistance is provided to computer users on campus relative to hardware and software use, communications, printing and planning a computer purchase. Based upon need, introductory and advanced training classes are provided regularly.

Telecommunication Services operates and maintains the campus-wide telephone system. It strives to keep equipment up to date in order to meet the college's varied communication requirements.

Continuing Medical Education

The Office of Continuing Medical Education is a leader in continuing education programming for osteopathic physicians licensed to practice in Texas. An extensive calendar of seminars on current medical topics serves practitioners throughout the state, both in rural and urban areas.

A CME-accredited audiovisual lending library, tailored to the needs of the osteopathic physician, also is available. To determine future continuing education requirements of the osteopathic medical profession in Texas, the office conducts a comprehensive needs-assessment program annually.

Research

Research in progress by TCOM faculty members encompasses a wide variety of biomedical topics and interdisciplinary programs between the basic and clinical faculty as well as between TCOM scientists and those at the University of North Texas.

Studies include the cause and control of disease; nutrition; immunology; toxicology; the biochemical, environmental and physiological aspects of aging; cardiovascular physiology; human metabolism and mechanisms of chemotherapy; drug interactions; chemical carcinogens; behavioral pharmacology; human fitness; and other areas.

Financial support for most of these individual research projects involves grants from the National Institutes of Health, American Heart Association, American Osteopathic Association, Robert A. Welch Foundation, National Science Foundation, and other public and private sources. In addition, state appropriations cover some organized research support that is distributed to individual faculty members on a competitive basis by an internal faculty research committee. Faculty members also have been recipients of Texas Advanced Research and Technology Program awards.

Modern research instrumentation is available to the faculty in Fort Worth and in Denton through UNT. Auxiliary services include a biomedical instrument repair division, animal-care

facilities and a medical library that offers a variety of computer-search services.

TCOM's basic science faculty members and specialized research laboratories are housed in both Medical Education Buildings 1 and 2, and AAALAC-accredited animal care facilities are located in Medical Education Building 2. The 10,000-square-foot vivarium, supervised by a full-time veterinarian, contains diagnostic laboratories, procedure room, surgical suite and X-ray equipment.

Center for Osteopathic Research and Education

The Center for Osteopathic Research and Education was established in 1982 to oversee the inclusion of the osteopathic philosophy into all instructional and research aspects of the college.

Specifically, CORE's responsibilities include converting the teaching of

osteopathic theory into a college-wide process; improving the understanding of osteopathic medicine by all college personnel; establishing standards in osteopathic philosophy, theory and practice for graduation; developing instructional materials appropriate to the teaching program; encouraging research related to osteopathic concepts; developing programs of continuing education in osteopathic philosophy, theory and methods; setting criteria for selecting faculty members capable of administering the envisioned programs; and setting criteria for selecting students capable of responding to such programs.

ONE

TWO

Admissions and Financial Aid

THREE

FOUR

FIVE

SIX

INDEX

Admission Requirements

Procedures

Fiscal Policies

Minority Students

Texas Residency

Procedures for Transfer

Student Financial Assistance

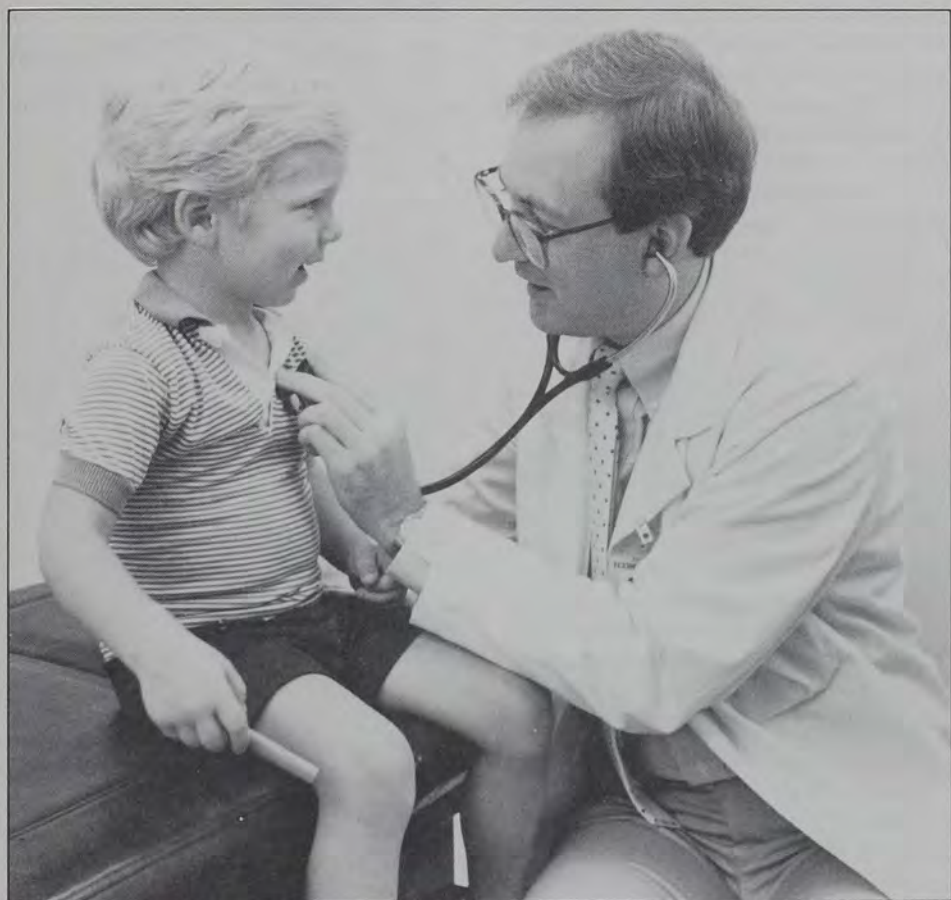

ADMISSION REQUIREMENTS

To be considered for admission to Texas College of Osteopathic Medicine a candidate must meet the following prerequisites:

- **New MCAT scores:** minimum composite MCAT score of at least 40, with a minimum reading subtest score of 6. The New Medical College Admission Test (MCAT) is required of all applicants. The New MCAT must have been taken no earlier than three years before application and no later than the fall of the year preceding that for which application is made. The spring MCAT test is preferred over the fall test, as the scores from the fall test may delay completion of an application.

Later test scores may be considered at the discretion of the Office of Admissions.

- **90 semester hours (or the equivalent number of quarter hours) at an accredited college or university.** Most applicants have earned the bachelor's degree by the time they matriculate in medical school.
- **One academic year or its equivalent in English, psychological-social-behavioral sciences, physics, biology, general chemistry and organic chemistry.** It is expected that laboratory work will be included in each of the basic sciences. Additional course work in the traditional basic sciences,

humanities and behavioral sciences is encouraged. The following courses are highly recommended, not so much for application purposes as for success in the medical school curriculum: comparative anatomy, physiology, microbiology, biochemistry, genetics and embryology.

• **Overall GPA and overall GPA in preprofessional science courses of 3.0 on a 4.0 scale at the time of application.***

Grades for courses in other professional fields, physical training and vocational courses will not be considered in determining the overall grade point average.

** All applicants are reviewed on an individual basis. The Admissions Committee reserves the option to waive a minimum academic requirement provided the applicant demonstrates superior performance in the majority of the remaining academic measures. Notwithstanding, consideration will not be given to an applicant presenting with less than a cumulative GPA of 2.5 on a 4.0 scale, either overall or in preprofessional science courses.*

The Admissions Committee will give priority consideration to those applicants with science and overall grade point averages of 3.2 or above on a 4.0 scale. The burden of proof of academic qualification rests with the applicant.

Applicants who have previously attended a professional school (medicine, law, dentistry, etc.) must have left that institution in good standing to be eligible for consideration by the Admissions Committee.

PROCEDURES

Texas College of Osteopathic Medicine is a participant in the American Association of Colleges of Osteopathic Medicine Application Service (AACOMAS).

Applicants using AACOMAS must be applying for the first year of study leading to the D.O. degree. Students applying for transfer should request application information from the TCOM Office of Admissions. (See Procedures for Transfer elsewhere in this catalog.)

The following guidelines should be followed:

The AACOMAS deadline for applications for the 1990 entering class is March 1, 1990.

AACOMAS application request cards may be obtained from the TCOM Office of Admissions or from a premed adviser. Applicants must mail the cards to AACOMAS for the applications and return the applications to AACOMAS. Applicants must request that an official transcript from each college and university attended be sent to AACOMAS.

Applicants must request that their MCAT scores be sent to those schools to which they are applying, using code number 600 (the designated number for all participating osteopathic colleges). Applicants will be sent copies of the applications standardized by AACOMAS, and biographic and academic profiles that they should check for errors.

If applicants have changed their names for any reason and have transcripts under those names, they must note this on the AACOMAS application.

A limited number of application fee waivers, designed to assist applicants with financial hardships, are available from AACOMAS for applicants to the 1990 entering class. For information on the fee waiver, see the AACOMAS

Instruction Booklet or contact the AACOMAS office.

The TCOM Admissions Committee will review only complete applications. These must include, in addition to the completed AACOMAS applications, the following items:

- 1. Completed TCOM Supplemental Application, including a recent photograph.** After review of the academic credentials, as shown on the AACOMAS profile, the Supplemental Application will be sent to those individuals eligible for further consideration. Items 2-7 will be requested through the Supplemental Application.
- 2. Non-refundable Supplemental Application fee of \$25, made payable to TCOM.**
- 3. Residence Status Form.** A notarized form is required for all Texas and out-of-state applicants. Only outstanding non-resident applicants will be considered for admission.
- 4. Evaluation and Interview Form** from an osteopathic physician, not related to the applicant by blood or marriage, whom the applicant chooses as a reference.
- 5. Official Premedical Advisory Committee Evaluation or two letters** from professors who are familiar with the applicant's academic work, one from a science professor and one from a professor in the applicant's major.
- 6. Letter of recommendation from the applicant's most recent employer.**
- 7. Two or more additional letters of recommendation regarding the applicant's personal attributes.**

It is the responsibility of an accepted applicant to provide official transcripts of all college and university course work to TCOM before registration. An applicant's acceptance is conditional until TCOM receives the official transcripts. Course work taken subsequent to application must be forwarded to TCOM at the end of each

successive semester. AACOMAS does not reproduce transcripts for the schools, and failure by the applicant to complete this requirement could result in unfavorable action for the applicant by the school.

Physical Examination

Physical examination forms are sent to all accepted applicants. The form should be completed by the applicant's physician or, if the applicant chooses, the physical examination may be performed by a physician at TCOM's Central Family Practice Clinic in Medical Education Building 1. There is no fee, except costs of laboratory tests as needed.

TCOM is in compliance with PL 504. The medical school does not discriminate on the basis of handicap in the recruitment and admission of students, the recruitment and employment of faculty and staff, and the operation of any of its programs and activities, as specified by federal laws and regulations. The TCOM director of personnel is the designated coordinator for college compliance with these regulations.

FISCAL POLICIES

TCOM is a state-supported institution subject to state laws. However, students have an option to pay tuition and fees by installment. All other financial obligations to the college must be paid in advance. Fees are subject to change by the Board of Regents, the Texas Legislature or legal rulings of the Texas attorney general.

Tuition

In-state resident tuition for 1989-90 is \$5,463.

Tuition for out-of-state residents and foreign students for 1989-90 is \$21,852.

Expenses

Estimated expenses for 1989-90 for nine months for a single student are \$17,590, including in-state tuition, fees, books, supplies, room and board, transportation and personal expenses.

Health Insurance

To safeguard against the cost of illness, injury and other medical expenses, all students are expected to provide for their own health-care coverage while attending TCOM. Students who have not provided for this coverage at the time of registration may choose to participate in a plan arranged through the Office of Student Affairs. The enrollment period is during fall registration.

Fees and Other Charges

Student Activity Fee: \$125 per academic year.

Building Use Fee: \$180 per academic year.

Property Damage Fee: \$10 one-time charge. Each student pays the deposit, which is refundable by request upon final withdrawal or graduation. If not claimed within four years after last enrollment date, the deposit is forfeited.

Student Identification Card: \$1. There is a \$5 additional charge for lost or replaced ID card.

Laboratory Fee: \$25 per academic year for first- and second-year students.

Cholesterol Screening Fee: \$11.50, Year I students only.

Late Registration Fee: first day, \$5; second day, \$7.50; third day, \$10; fourth day, \$12.50; fifth day, \$15; sixth day, \$15.

Graduation Fees: \$30 one-time charge, levied at the beginning of the fourth academic year. Arrangements for regalia, for which there is an additional fee, will be made through the college.

Transcript Fee: \$2 per copy. The first TCOM transcript is free.

Photocopy Fee for Diploma: \$5 per copy.

Returned Check Service Charge: Any check returned to the college must be redeemed by the person writing the check. A service charge of \$5 must be paid.

Microscope Fee: \$50 per nine-month academic year (September 1-May 31) for first- and second-year students. Microscopes are used for laboratory instruction in the Departments of Anatomy, Microbiology and Immunology and Pathology, according to procedures established by the departments.

Reproduction Fee: Year I students will pay \$148 and Year II students \$208 for reproduction of course syllabi and manuals.

Special Examinations: These are based on the charge of the examining body or agency at the time of the examination.

Tuition Refund Policy

A tuition refund is based on the date of withdrawal. A request for withdrawal must be submitted to the vice president for academic affairs and dean, and a withdrawal form must be signed by the registrar. Upon official notification of withdrawal by the registrar, the Accounting Office will mail the refund to the student's forwarding address. (See other withdrawal information elsewhere in this catalog.)

Laboratory fees, late fees and ID card fees are not refundable.

By action of the Board of Regents, no part of the fees or tuition can be refunded to students who withdraw, for any cause, after the twentieth day of each semester. The schedule for refunds under the regulations is 80 percent first week, 70 percent second week, 50 percent third week and 25 percent fourth week.

MINORITY STUDENTS

TCOM actively recruits qualified minority students and encourages them to apply. Tutoring and counseling are available.

TEXAS RESIDENCY

The rules and regulations for determining residency status are set forth by the Coordinating Board, Texas College and University System.

Questions regarding these requirements should be referred to TCOM's Office of Admissions or Office of the Registrar.

Non-resident Students

Texas residents are given admission preference by State of Texas legislative mandate. Only a few outstanding non-resident applicants will be considered for admission. Preference will be given to those applicants from the south and southwest regions of the United States.

Foreign Students

An alien living in the United States under a visa permitting permanent residence, or one who has filed with the proper federal authorities a declaration of intention to become a citizen, has the same privilege of qualifying for Texas residency status for tuition purposes as has a citizen of the United States.

PROCEDURES FOR TRANSFER

Students enrolled in other osteopathic and non-osteopathic (M.D.) medical colleges may request transfer to TCOM. In general, approved transfers into the academic program will be limited in number. The primary entrance into TCOM is through its regular admissions program.

Applications for transfer will be evaluated on an individual basis, and exceptional circumstances will be given careful consideration. However, the following guidelines will apply:

- Applicants for transfer must be in good standing at their current institution.
- Preference will be given to students from colleges of osteopathic medicine approved by the American Osteopathic Association. Approval for transfer of students from non-osteopathic (M.D.) medical schools is limited to individuals who demonstrate specific understanding of and dedication to the philosophy, principles and practice of osteopathic medicine.
- Preference will be given to students who qualify for Texas residency status and/or those who demonstrate an intention to practice in the state of Texas.
- Review of individual applications will be restricted to those persons who are certified to be in good standing at the institution formerly attended.
- Transfer must be made no later than the beginning of the third academic year at TCOM. Applicants for transfer should have completed the preclinical portion of their programs and should have successfully completed at the time of transfer Part I of the examination administered by the National Board of Examiners for Osteopathic Physicians and Surgeons Inc. Except under unusual circumstances, transfer should take place only at the beginning of an academic term. Students must complete a minimum of two academic years in residence at TCOM.
- An applicant for transfer must present a completed application for transfer and a written recommendation from the dean of the institution from which transfer is requested. Official academic transcripts from all previously attended colleges and universities must be provided. A personal interview is required.

STUDENT FINANCIAL ASSISTANCE

Texas College of Osteopathic Medicine offers a number of scholarship and loan programs to assist students in meeting the costs of financing a medical education. Though financial aid is an alternative for most students, it should be considered a supplement to a student's own financial resources.

A student may apply for financial aid by completing the Financial Aid Form (FAF) from College Scholarship Service (CSS). This should be done immediately upon acceptance to TCOM and yearly thereafter.

Federal Programs

Students that complete the FAF, show financial need as determined by the needs-analysis service and meet all general eligibility requirements as outlined for each program may apply for federal financial aid. In addition, most aid programs require that the recipient adhere to academic and/or financial criteria in order to maintain eligibility. Some programs have limited funds; therefore, student files that are completed first are considered first. Federal programs available include:

- *College Work Study (CWS)*
- *Disadvantaged Health Professions Program*
- *Exceptional Financial Need Scholarship (EFN)*
- *Guaranteed Student Loan (GSL)*
- *Health Education Assistance Loan (HEAL)*
- *Health Professions Student Loan (HPSL)*
- *Perkins Loan (formerly NDSL)*
- *Supplemental Loans for Students (SLS)*

Military Programs

Students interested in military programs should contact their local recruiter or one of the following recruiters in the Metroplex:

United States Air Force
2615 Avenue E East, Suite 121
Arlington, TX 76011
(817) 640-6469

United States Army Medical Department
1100 Commerce St., 1-B20
Dallas, TX 75242-0999
(214) 767-0818

United States Navy
319 W. 10th St.
Fort Worth, TX 76102-4691
(817) 334-2777

Other Scholarship and Loan Programs

Students may apply through TCOM's Financial Aid Office for the following institutional private and state scholarship/loan programs:

- **Scholarships**
 - Dean's Tuition Scholarship*
 - Robert G. Haman Scholarship*
 - Mavern Devine Kinzie Scholarship*
 - Earl H. Mann Scholarship*
 - Susie B. Neel Scholarship*
 - Minority Tuition Waiver Scholarship*
 - Wayne O. Stockseth Scholarship*
 - Texas Public Education Grant*
- **Loan Programs**
 - TCOM Alumni Association Loan Program*
 - Student Associates Auxiliary Loan Fund*
 - Horace A. Emery Loan Program*
 - Dorothy J. Crow Loan Program*

Etta O. Newby Loan Program
William H. Ferguson Loan Program
*Robert Wood Johnson Student Loan
Fund*
*Mexican-American Physicians
Association Student Loan Program*
*M. Vernon Morgan Student Loan
Fund*
Joe J. Rady Loan Fund
*James G. Sanders Jr. Emergency
Loan Fund*
*Ruth Meadow Thompson Loan
Program*
TOMA Emergency Relief Loan Fund
TCOM Emergency Loan Fund
Shirley Waldron Loan Fund

In addition, students may apply directly to several private foundations for scholarships and loans. Several programs have individual selection criteria and various award limits. For a complete listing contact the Financial Aid Office.

ONE

TWO

THREE

Scholastic Regulations

FOUR

FIVE

SIX

INDEX

Student Responsibilities

Registration

Records

Grades

Course/Instructor Evaluation

Special Academic Programs

Academic Standing

Promotion Requirements

Withdrawal, Leaves and Dismissal

Requirements for Graduation: Class of 1993



STUDENT RESPONSIBILITIES

Each student enrolled in the college is individually responsible for knowing current scholastic regulations, the general and specific requirements, and the operational policies that apply to registration and instruction.

Scholastic Regulations

This catalog contains the official scholastic regulations of the college. Academic policies and scholastic regulations also are presented in the Student Handbook and other official documents of the college.

A student who completes the curriculum in four consecutive years is required to meet the graduation require-

ments listed in the catalog of entry and/or any subsequent or additional program requirements. In the event of an extension beyond the four years, the student must meet the requirements for the class with whom the individual graduates.

The college reserves the right to amend or add to the scholastic regulations at any time during the enrollment period provided that such changes or additions are intended to improve the quality of medical education in the college, and are introduced in a fair and deliberate manner with appropriate notice provided to all students affected by the changes.

A student who is required to repeat an academic year will meet all graduation requirements listed in the catalog in effect for the class with whom the individual graduates.

A student who is required to repeat or remediate courses may be subject to certain scholastic regulations other than those established for the student class with whom the individual entered the college, as determined by the vice president for academic affairs and dean.

Course Syllabus

The course syllabus contains specific educational requirements-- assignments, evaluation, grading and other conditions of performance -- that must be satisfactorily completed in order to receive a passing grade. Modifications to the requirements and procedures of a course may be made when judged necessary to improve instruction or to conform to scholastic regulations of the college.

Attendance

One hundred percent attendance is expected of all students at all lectures, laboratories and clinical assignments. There are no excused absences. It is recognized that there may be isolated instances when an individual must be absent; however, the student who misses a class is not excused from the subject materials presented during the lecture or laboratory period.

No makeup laboratories will be conducted. In the rare event of absence from an examination, written permission to take a makeup examination must be obtained from the associate dean for basic sciences or associate dean for general or specialty medicine and the department chairman. It is essential that each student make every effort not to miss an examination.

As professionals, students are expected to adhere to this attendance policy with diligence.

Additional requirements for attendance are contained in the course syllabus. *A failing grade will be recorded for any course in which a student has both more than 30 percent absences and a final course grade of 74 or less.* In this event, a student shall be required to repeat the course at the next regularly scheduled time during the next academic year. In the event that a student receives a final course grade of at least 75, the earned grade for that course will be recorded without regard to the attendance record in that course and no other academic work will be required in that course despite the fact that more than 30 percent absences in that course may have been recorded.

Students may receive excused absences for certain college-related activities. These absences will not be included in the 30 percent attendance requirement. No absences will be excused without written approval, in advance, from the vice president for academic affairs and dean.

Participation in Special Environments

Medical education occurs in a special environment in which all students will participate in order to satisfactorily complete the course of instruction. Classrooms, laboratories and clinical facilities require physical, chemical, social and interpersonal environments in which each student must participate in order to accomplish the educational requirements established for all courses. Failure to participate in required academic classes will result in consideration for dismissal from the college.

REGISTRATION

Registration is conducted annually in summer at TCOM for the first-, second- and third-year students. Fourth-year students register by mail.

Registration consists of paying tuition and fees and completing registration forms for the Office of the Registrar, Financial Aid Office and Office of Student Affairs.

Student may register for and attend only those courses and clinical rotations listed on their official academic schedules of classes, as approved by the vice president for academic affairs and dean. Students may not be enrolled in two or more courses meeting at the same time.

Only students properly enrolled by the registrar may attend classes. Any examinations or other materials completed by an individual who is not officially enrolled will be destroyed. No record will be kept of examinations or other academic work done by individuals whose enrollment in a course has not been authorized by the registrar. Examinations or other course materials completed by a dismissed student who is attending classes while under an official appeal will not be scored and will be retained by the registrar pending outcome of the appeal.

Late fees are assessed for each day following the designated date of registration. A check returned because of insufficient funds will incur a penalty and also may result in a charge for late registration. (See Fiscal Policies for more information.)

RECORDS

Transcripts

The term academic transcript refers to a copy of the official permanent record of a student's approved academic course work, including academic marks, scholarship and degrees. At the student's request, a class rank may be

shown on the transcript. To obtain an official academic transcript, a signed and dated Release of Information Form must be completed by the student and filed with the registrar. Any transcript provided directly to a student must be regarded as unofficial. The transcript must be mailed directly from the Office of the Registrar to the receiving institution in order to be regarded as an official academic record.

Students may obtain copies of their transcripts by submitting written requests to the Office of the Registrar. The first copy of the TCOM transcript is free. A \$2 fee is charged thereafter for each official transcript. A \$1 fee is charged for each copy of an undergraduate transcript in a student's file.

Acts of the 61st Texas Legislature, Chapter 675, 1969 Regular Session, provide legal penalties for any alteration of academic records or transcripts with the intent to use such a document fraudulently. A person who violates this act or who aids another in violating this act is guilty of a misdemeanor and upon conviction is punishable by a fine of not more than \$1,000 and/or confinement in the county jail for a period not to exceed one year.

Accessibility of Student Records

The Family Educational Rights and Privacy Act of 1974, also known as the Buckley Amendment, grants students in institutions of higher education the right of access to their educational records. It grants students the right to inspect their educational records, with the exception of confidential letters and statements of recommendation that the student has waived the right to inspect.

Before disclosing any personally identifiable information, TCOM must obtain written consent from the student.

The Family Educational Rights and Privacy Act considers certain information to be "directory information" and subject to disclosure without prior

consent from the student. Directory information relating to students includes the following: the student's name, address, telephone listing, date and place of birth, hometown, major field of study, participation in officially recognized activities and sports (including weight and height of members of athletic teams), classification, degrees and awards received, the most recent educational agency or institution attended by the student and the dates of attendance.

Students who desire that all or part of their directory information not be released must submit a written request to the Office of the Registrar during the first 12 days of the fall semester. Forms for submitting the written request to withhold directory information are available in the student's fall registration packet and in the Office of the Registrar.

Grades and other academic evaluations will be made available to the vice president for academic affairs and dean and to other college personnel as the vice president for academic affairs and dean may direct so as to carry out administrative and academic responsibilities of the college.

TCOM will notify students in writing of the academic offices in which their educational records are maintained at fall registration each year.

GRADES

Numerical Course Grades

The grading standard for all TCOM courses will be a numerical system ranging from 0 to 100, with 70 as the lowest passing grade. A grade of 69 or less is defined as a failing grade. Numerical course grades will be rounded off to the nearest whole number (e.g., 69.1 to 69.4 will be recorded as a 69; 69.5 to 69.9 will be recorded as a 70.)

For purposes of promotion and graduation, a cumulative weighted average of

70 or better is required. The weighted average for a block or semester is determined by dividing the total number of grade points earned by the total number of hours attempted, excluding courses in which a "CR" grade is achieved.

Grade points for a course are the product of the number of hours for that course and the numerical grade received. If the numerical grade is below 70 (69 or less), the earned grade points will be given for that course. The cumulative weighted average is obtained by dividing the total number of grade points earned in all courses by the total hours of all courses attempted. (See Remedied Grades.)

Grade Symbols and Designations

W: Withdrawal in good academic standing or Withdrawal not in good academic standing. **WP:** Withdrawal passing. **WF:** Withdrawal failing. **NC:** No credit. **CR:** Credit. **I:** Incomplete. **AUD:** Audit.

Recording Grades

No grade except an "I" (Incomplete) shall be removed from a student's official permanent record once properly recorded, except in the case of inaccurate reporting or recording. It is assumed that faculty members exercise their best judgment in formulating grades. Changes are not permitted after grades have been filed with the registrar, except to correct clerical errors. A request for error correction must be initiated within 30 days after the close of the semester or term for which the grade was awarded. Requests for correction after 30 days require approval of the vice president for academic affairs and dean.

Appropriate payment of tuition and fees must be made in order for final course grades to be entered in the student's official permanent record. Grades assigned during a period of

instruction for which there are unpaid tuition and fees will be made available by the registrar for official college purposes, such as the review of academic performance. However, those grades will not be entered on the student's official permanent record or released on an academic transcript until appropriate payment is received by the college.

Incomplete Grades

At the end of a course a grade of "I" (Incomplete) will be assigned only when a student has not completed all academic requirements and assignments in the course, including regular examinations. The work that was incomplete must be completed within one calendar year from the end of the semester in which the incomplete grade was assigned. An incomplete grade becomes a failure after one year if the work is not satisfactorily completed. A student will not be promoted to clinical rotations with an incomplete grade without prior approval of the vice president for academic affairs and dean.

Semester Grades

Grades are reported to the Office of the Registrar within seven working days of the conclusion of a course.

Grades are mailed to students at the end of each semester. The semester grade report includes grades for the present academic term as well as the cumulative weighted average earned throughout the academic program.

Grades will not be released over the telephone and will be kept in confidence.

Students who fail an examination are required to consult with the course director within five working days following notification of the failed examination.

Remedied Grades

A student who receives a failing grade (69 or less) in a course will have to repeat that course in accordance with the promotion requirements and achieve either a grade of 70 or a "CR." Failure to achieve either a grade of 70 or better or a "CR" in a remedied or repeated course is grounds for dismissal.

When a course is repeated or remedied, all attempted credit hours and earned grade points are counted in computing the cumulative weighted average. An asterisk is placed next to these courses to indicate that the course has been repeated. Entries for the repeated course and the remedied grade are shown elsewhere on the transcript.

COURSE/INSTRUCTOR EVALUATION

Each student has a responsibility as a professional to provide constructive evaluation of each course, clinical rotation and instructor in the curriculum. This responsibility will be met by participation in the course evaluations routinely administered by the college.

According to the Administrative Policy on Student Evaluation of Courses and Instructors, each student is required to complete course/instructor evaluations in order to receive a grade for the course. If a student fails to complete course/instructor evaluations, grades earned in the applicable courses will be made available by the registrar for official college purposes (such as the review of academic performance) but will not be entered on the student's official permanent record or released on an academic transcript until satisfactory completion of the course/instructor evaluations.

SPECIAL ACADEMIC PROGRAMS

A student may request the privilege of a special academic program under extenuating circumstances. Requests to be considered for a special academic program will be directed to the vice president for academic affairs and dean, who will act on the request after consultation with the Student Performance Committee, Office of Academic Affairs and appropriate faculty members. There is no assurance that requests will be granted.

Guidelines for a special program are as follows:

- Requests for a special program must be made either before enrolling in the fall semester of the freshman year or within three weeks after the beginning of the first semester of each year of classes.
- No request will be considered at any other time in the year unless there is documented evidence of a medical or personal problem that would prevent the student from completing the year with a full course load. Under no circumstances will special programs be granted to students only for reasons of not being in good academic standing or to students who have not applied themselves in studies, including attending class. Furthermore, students should have indicated, as proven by their efforts at TCOM, that they have the characteristics to be successful in the college curriculum.
- Any student (other than a transfer student) granted a special program will be placed on a five-year program. All academic and non-academic requirements of the college will apply to any student on a special program.

Auditing

Students may audit classes if they have obtained permission from the vice president for academic affairs and dean and have paid all tuition and fees.

These students will be expected to meet all classes and take examinations unless prior arrangements have been made with the course director and department chairman. No grades will be given for audited classes, but these courses will be shown on the academic transcript.

ACADEMIC STANDING

Advanced Placement

A student may be considered for advanced placement or waiver in a particular course only at the time of admission regardless of the mechanism and level of the admission. The advanced placement, if granted, will be specified in the student's registration package.

To be placed in advanced standing a student must have taken a course judged equivalent by the appropriate academic department within two years before the date of admission and must have been awarded a minimum grade of "B." Candidates who fail any of these criteria may still be recommended for advanced placement by a department if they have completed a similar course and have obtained a minimum grade of 80 or above in a written comprehensive examination given by the department for advanced placement purposes before their admission to TCOM.

Requests for advanced placement or waiver must be made at the time of the student's verification of acceptance when the student must present all supporting documents to the appropriate academic department through the Office of the Registrar. The departmental recommendation will be reviewed in the Office of Academic Affairs and must be approved by the vice president for academic affairs and dean.

The decision regarding a request for advanced standing will be transmitted in writing to the student by the vice president for academic affairs and dean, who also will instruct accordingly the registrar and the concerned department.

Courses for which advanced standing is granted will be assigned the grade "CR," which will not contribute to the student's cumulative weighted average.

National Boards

All students are required to take Part I of the examination administered by the National Board of Examiners for Osteopathic Physicians and Surgeons Inc. upon completion of the second year of the medical curriculum. A student is eligible to take Part I upon satisfactory completion of one-half of the sophomore year. To be eligible, a student must have received a passing grade in courses totalling one-half of the semester credit hours in the sophomore curriculum.

A student is required to pass Part I (per the minimums established by the National Board of Examiners) for promotion to the third year. Students who do not pass Part I will be allowed to remain as provisional students in the third year and will be required to retake the examination at the regularly scheduled examination period in the fall of the third year. These students will be allowed to continue in the junior classification on a provisional basis pending results of the second examination.

A student who does not achieve a satisfactory result on the second examination will not be allowed to commence clinical rotations upon completion of fall courses of the junior year curriculum and may be considered on an individual study status.

Students may audit appropriate basic science courses in order to prepare for re-examination with the approval of the vice president for academic affairs and dean, department chairman and the course director.

Students may take a third National Board examination at the next regular testing period. Students who are taking the exam for the third time will not be

allowed to commence clinical rotations until results are received by the registrar.

Students who do not achieve a satisfactory score on the third and final examination will be dismissed from the college. Students who achieve a passing score on any attempt as described above will commence clinical rotations and be promoted without record of any deficiency.

All students are required to take Part II of the examination administered by the National Board of Examiners for Osteopathic Physicians and Surgeons Inc. in the fall of their fourth year. A student is required to pass Part II (per the minimums established by the National Board of Examiners) for graduation.

Students who do not pass Part II will have a second opportunity to take the test during the spring of the fourth year. Students who are unsuccessful on the second try must take a third examination at the next regular testing period. In that case, graduation will be delayed until notification of successful passage of the examination. Students who do not pass Part II of the National Boards after three attempts will be dismissed from the college.

Senior Examination

Each student will sit for a comprehensive examination prepared by the faculty and administered during the fourth year.

Final Examinations

No student will be exempt from taking final examinations. No final examination will be given early or late, except in the case of unusual circumstances acceptable to the course director, the department chairman, and the vice president for academic affairs and dean. Each case of this type will be considered on its individual merits.

Academic Honors

It is a tradition at TCOM to recognize its highest scholars and to promote academic excellence throughout the college program. Honors are determined after each academic semester and at graduation and are noted on the student's official permanent record.

Each semester the Dean's List recognizes those students whose cumulative weighted averages make up the highest 10 percent of each class enrolled in the college.

The distinction of President's Scholar is awarded to those graduating seniors who have been named to the Dean's List for every semester of enrollment in the college.

Academic honors are awarded with the degree at graduation ceremonies to the graduates whose cumulative weighted averages make up the highest 10 percent of the graduating class. The students in this group shall be designated as graduating with honors.

No graduate will be named to the Dean's List or receive a degree with honors who has failed a course, who has not been enrolled as a full-time student or who has been placed on academic or disciplinary probation.

PROMOTION REQUIREMENTS

Normal progression through the curriculum requires that a student achieve a cumulative average of at least 70 in each academic year and that there be no failing grades (below 70) that have not been corrected. Achievement of this standard in each academic year is required for promotion to the next academic year. This standard also must be met before a third-year student will be allowed to begin clinical rotations. The same standard must be achieved in the fourth year in order to graduate. In addition, the graduating student must have passed Parts I and II of the examination administered by the National Board of Examiners for

Osteopathic Physicians and Surgeons Inc. and must have sat for the senior comprehensive examination.

The academic standards for successful completion of each course or clinical rotation are determined by the department or interdisciplinary unit under which the course or rotation is administered. The student has the primary responsibility for acquiring knowledge and clinical proficiency and for meeting the academic standards set for each course or program. The college in no way guarantees that any student once enrolled will achieve any level of academic or professional accomplishment.

Students who do not meet the standards specified for promotion, for beginning clinical rotations or for graduation may be given an opportunity to correct their deficiencies either at specified times during the academic year or by adding an additional period of time to their medical education as described under "Promotion Requirements" in the Student Handbook.

Academic Probation

Students must meet the minimal standards and requirements set by the college in order to remain in good academic standing. Students will be placed on academic probation if they have a cumulative weighted average of less than 70 or if a failing grade is received in any course. They will be removed from academic probation only after successfully correcting their particular deficiency.

Academic standing is reviewed by the Student Performance Committee periodically throughout the year and includes consideration of a student's overall performance at TCOM during any and all periods of enrollment. Academic probation or other actions may be recommended for students with failing grades and a cumulative weighted average below 70 or for

students whose performance in a number of courses is passing but low (such as a grade of 70-74). In addition, students may be placed on academic probation for ethical, professional or personal standards that fall below those established by the college.

Academic probation should be regarded as a serious matter and is official notice to students that the quality of their performance during the probationary period must improve in order to remain eligible to continue in the college. Any students who fail to improve their performance in the areas identified by the Student Performance Committee during the probationary period may be continued on probation, asked to withdraw or dismissed from the college.

WITHDRAWAL, LEAVES, DISMISSAL

Withdrawals

An application for voluntary withdrawal from the college must be made in writing to the vice president for academic affairs and dean. The application will be accompanied by a personal interview except in rare and special circumstances. Every effort should be made to assure that no misunderstandings or errors occur in the withdrawal process.

An entry will be made on the official permanent record indicating the academic standing of the student at the time withdrawal is granted. "Withdrawal in good academic standing" will be recorded provided the student is not on academic probation and has received no course grades or averaged examination grades of less than 70 during the semester in which the withdrawal is requested. "Withdrawal not in good academic standing" will be recorded if the student is on academic probation or has received course grades or averaged examination grades of less than 70 during the semester in which the

withdrawal is requested.

In addition, students must report to the Office of the Registrar to sign a withdrawal form before they can officially withdraw from the college. Students who do not complete this application for voluntary withdrawal will not be entitled to an official withdrawal and will not be considered for readmission at a later date.

Readmission following the withdrawal procedure is not assured unless it is a part of the final decision and/or agreement made by the withdrawing student and the vice president for academic affairs and dean. This final decision and/or agreement must be in writing so that it is clear to all involved parties.

Leaves of Absence

A student in good academic standing may request a leave of absence in the event of a medical problem. Students requesting a leave of absence must inform the vice president for academic affairs and dean in writing. The request must be accompanied by a letter from a physician describing the nature of the disability for which the leave is requested and the estimated length of time needed for recovery.

After consultation with the student, the vice president for academic affairs and dean will decide whether or not the leave is to be granted and the conditions under which the student may return to school.

Before a student is readmitted, a written request for readmission must be submitted by the student to the vice president for academic affairs and dean. A letter from a physician stating that the student has recovered from the disability for which the medical leave was granted and is able to participate in a full academic program must accompany the readmission request.

Students must report to the Office of the Registrar to sign a leave of absence

form before they can leave the college officially.

Dismissal

Dismissal from the college will be recommended if:

1. a student's cumulative weighted average for any one academic year is less than 70.
2. a student earns failing grades in 25 percent or more of the credit hours for any one academic year.
3. a student fails a course or rotation for the second time (no readmission would be granted at a later date).
4. a student exceeds the two-year maximum limit for completing one academic course or the six-year limit for completing requirements for graduation, exclusive of a leave of absence or withdrawal in good standing.
5. a student has not demonstrated continued academic and professional growth and achievement.
6. a student has not passed the National Board examinations as set forth in the policy by the National Board of Examiners for Osteopathic Physicians and Surgeons Inc.

Students will be recommended for unconditional dismissal with no opportunity for readmission if they withdraw or are dismissed due to poor academic progress, subsequently re-enter the college and then receive a failing grade in any course.

It should be clearly understood that the college, after due consideration and process, reserves the right to require the dismissal of any student at any time before graduation if circumstances of a legal, moral, behavioral, ethical, health or academic nature justify such an action.

REQUIREMENTS FOR GRADUATION: CLASS OF 1993

Students who have satisfactorily completed all academic requirements and who have been recommended by the TCOM faculty may be awarded the doctor of osteopathy (D.O.) degree, provided they are of good moral character and that they:

1. have maintained at least a cumulative weighted average of 70, have no unremedied failing grades and no grades of "I" ;
2. are at least 21 years of age;
3. have been in residence for four academic years at an accredited college of osteopathic medicine or college of medicine, the last two years of which must have been at TCOM;
4. have passed Part I and Part II of the examination administered by the National Board of Examiners for Osteopathic Physicians and Surgeons Inc.;
5. have taken the comprehensive examination prepared by the faculty and administered during the fourth year;
6. have complied with all legal and financial requirements of the college;
7. have exhibited the ethical, professional, behavioral and personal characteristics necessary for the practice of osteopathic medicine;
8. attend the commencement at which the degree is to be awarded (only in unusual circumstances and with approval of the president will a degree be awarded in absentia); and
9. have completed the Clearance Check Form from the Office of the Registrar. This form, which must be returned to the registrar before graduation, is placed with the student's permanent record and serves as the final clearance from campus.

Students who do not fulfill all graduation requirements by graduation day will not be allowed to participate in the commencement ceremony. In

addition, they will not be considered graduates in any capacity until they have successfully completed all requirements.

ONE

TWO

THREE

FOUR

Curriculum Description

FIVE

SIX

INDEX

Curriculum Description

Program of Instruction

Curriculum Development

Curriculum

Course of Study

Other Graduate Degree Programs

Postgraduate Programs

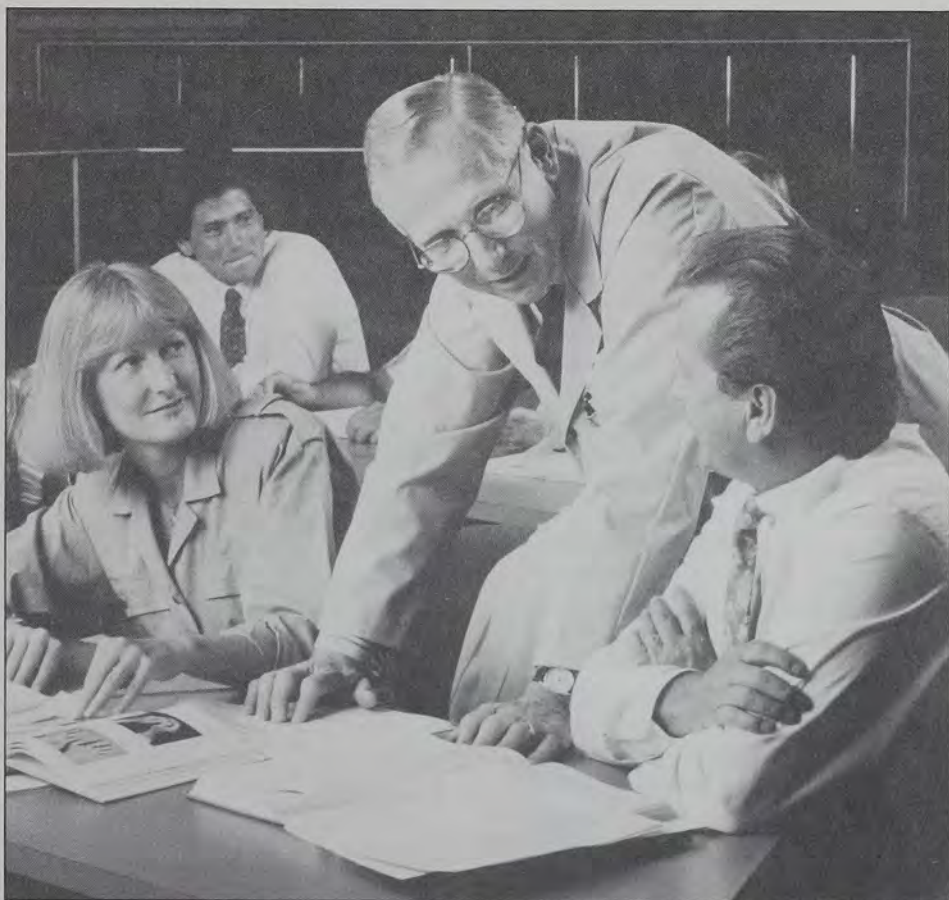

CURRICULUM DESCRIPTION

The Texas College of Osteopathic Medicine curriculum is a four-year program leading to the degree of Doctor of Osteopathy. Increasing emphasis is being placed on the promotion of health and wellness in patients and on the necessity of treating each patient in the context of a wide variety of factors that influence health.

Semesters 1 and 2 of the first year are devoted to instruction in the preclinical sciences in concert with the fundamental clinical concepts and techniques of the osteopathic physician's approach to the patient. Materials are integrated wherever possible to enhance learning and comprehension.

Semesters 3-5 are increasingly

devoted to instruction in the clinical sciences in preparation for clinical clerkship rotations and preceptorships.

The final one and three-fourths years are devoted to clinical clerkship rotations and preceptorship assignments. During Semesters 6-8 each student rotates through a series of preceptorships and clinic and hospital clerkships. These four-week rotations are scheduled primarily in physicians' offices, college clinics and college teaching hospitals in or near the Fort Worth/Dallas area.

Semester 8 also includes clinical and classroom activities that are designed to round out each student's preparation for graduation. During this final semester

each student prepares for comprehensive examinations and attends short courses and seminars on campus.

PROGRAM OF INSTRUCTION

The instructional program at TCOM involves a variety of teaching methods and settings in order to prepare each student for the increasingly complex role of the physician in modern society.

While much of the instruction in the first five semesters takes place in the familiar classroom setting, the use of other teaching methods is increasing. Numerous opportunities are provided for laboratory instruction in the preclinical sciences. Other techniques being implemented involve the use of computer-assisted instruction, small-group teaching and simulated clinical experiences.

Beginning with the first semester, students are placed in a variety of community-service agencies throughout Fort Worth to help them become familiar with the many health-related agencies in the community and the health problems with which such agencies deal.

During the second year, students are assigned to the office of an area osteopathic physician to experience firsthand the activities of general practice and to provide a gradual transition from the classroom to clinical settings.

Use of Animals in Teaching

Animal use in teaching serves an indispensable purpose in the instructional programs of TCOM. The decision to use animals in teaching exercises is made entirely by the concerned department after careful consideration of the intended learning goals. The TCOM faculty is committed to the humane use and treatment of animals and will follow the National Institutes of Health Guide for the Care and Use of Laboratory Animals.

CURRICULUM DEVELOPMENT

Faculty, administration and staff at TCOM are dedicated to the principles of academic excellence and constantly strive to improve the quality of the educational program.

It is intended that each student will develop skills in self-learning and self-evaluation that will serve during formal medical education and throughout a professional career. Emphasis is placed on learning activities that assist each student in interacting effectively with peers and in promoting cooperative relationships with others in the health professions. Central to all educational activities in the curriculum are the goals of teaching critical thinking and of helping each student develop logical skills of clinical problem solving.

TCOM's administration and faculty have committed themselves to progressive revision of the curriculum in order to improve the probability that graduating physicians will increasingly transfer their clinical efforts:

- *from therapy to prevention*; that is, from remedial medicine to prophylactic medicine.
- *from late-stage disease to early departure from health.*
- *from pathologic medicine to physiologic medicine*, in order to help patients achieve and continue on their best physiologic path.
- *from treating disease to teaching healthful living*, especially by example.
- *from intervention in the biologic processes to the search for optimal operation by improving the conditions in which they function.*
- *from a focus on parts of the body to a focus on the total person as the context in which the parts operate.*
- *from the physician to the patient as the source of health and the agent of cure.* The physician's objective is to support and disencumber the natural processes of homeostasis, healing and recovery, and to place the patient in command of the situation.

- *from* a preoccupation with disease processes *to* concern about disease origins; that is, from causes of diseases to the factors that permit them to become causes.
- *from* specificity and multiplicity of disease *to* susceptibility to illness in general.
- *from* acute, crisis and episodic treatment *to* long-term care.
- *from* addressing acute episodic problems in isolation *to* dealing with them in the context of the total life and health of the patient.
- *from* an emphasis on depersonalized technology *to* a heightened awareness of human values and individual uniqueness.

This proposed transfer of emphasis is not intended to abandon one kind of clinical objective and effort for another. In the face of existing and accumulating disease and disablement, it will still be necessary to prepare students adequately for acute, crisis and episodic care as well as for prevention; for recognition of the occasional need for intervention in biologic processes as well as for improved operating circumstances; and for differential diagnosis and appropriate treatment of victims of specific illnesses as well as susceptibility to illness in general.

The goals of this educational program differ from those of traditional medical education. Implementation of these goals in the curriculum will be a gradual process. Ultimately, fundamental changes will be made in curriculum design and teaching-learning processes, composition and roles of the faculty, student selection, educational facilities and resources and, most importantly, the attitudes and professional qualifications of TCOM graduates. Implementation of these goals will be a major step toward meeting the health-care needs of Texas and the nation.

CURRICULUM

Year 1, Semester 1

Biochemistry
Developing Dimensions in Health Care I
Embryology
Gross Anatomy
Medical Histology
Osteopathic Clinical Practices I

Year 1, Semester 2

Basic and Clinical Immunology
Developing Dimensions in
Health Care II
Medical Physiology
Neurobiology
Osteopathic Clinical Practices II

**Also to be taken in
Semesters 1 and/or 2:**
Computer Literacy I

Year 2, Semester 3

Developing Dimensions in
Health Care III
Medical Microbiology
Osteopathic Clinical Practices III
Pathology I
Pharmacology
Psychiatry

**Also to be taken in
Semesters 3 and/or 4:**
Computer Literacy II

Year 2, Semester 4

Anesthesiology
Clinical Biochemistry
Developing Dimensions in
Health Care IV
Gynecology
Medicine
Osteopathic Clinical Practices IV
Pathology I (cont'd.)
Pathology II
Pediatrics
Psychiatry (cont'd.)
Surgery

Year 3, Semester 5

Clinical Problem Solving (elective)
Dermatology
Introduction to Advanced Cardiac Life
Support
Medicine (cont'd.)
Obstetrics
Pediatrics (cont'd.)
Radiology
Sociocultural Impacts on Health Care
Surgery (cont'd.)

Year 3, Semester 6 and

Year 4, Semester 7

Core Clerkships:

Ambulatory Care
Emergency Medicine
General Practice Junior Partnership
Medicine
Mental Health
Obstetrics and Gynecology
Pediatrics
Subspecialty Internal Medicine
Surgery

Elective Clerkships

Year 4, Semester 8

Advanced Cardiac Life Support
Certification
Medical Jurisprudence
Special Guest Speakers

COURSE OF STUDY

One semester hour equals 16 hours of scheduled instruction, including examinations and exclusive of clinical clerkship rotations.

Determination of the appropriate credit hour distribution for each course is recommended annually by the Curriculum Committee after consideration of the credit hour distribution as recommended by the course director and the department.

The three or four digits of a course number assist in identifying the type of course, course series and semester in which it is taught. A first number 5 refers to courses in the basic sciences division; 6 indicates clinical sciences, including pathology; 7 is a required clinical clerkship rotation; 8, an elective clerkship rotation; and 9, an interdepartmental or other special course. The second digit indicates the semester the course is begun, from 1 for the first semester of the first year to 8 for the second semester of the fourth year. The third and/or fourth digits are sequential numbers for course identification purposes.

Several courses listed are taught cooperatively by faculty from several departments. Interdepartmental teaching is encouraged in all phases of the curriculum.

DEPARTMENT OF ANATOMY

Gary E. Wise, chairman

Professor

Wise

Associate Professors

Aschenbrenner

Carnes

Orr

Rudick

Schunder

Wordinger

Assistant Professors

Bourdage

Cammarata

Dzandu

Jackson
Lieska

5101. Gross Anatomy

A complete study of the gross morphological features of the human body with organizational lectures and the systematic dissection of a human cadaver. The complete dissection of a human cadaver is required of all students for successful completion of the course. Lectures and dissection laboratory sessions will be integrated with living anatomy laboratories during which students identify the surface locations of important organs on fellow students by using body landmarks as guides. The body will be studied using a regional approach. Regions to be studied include: upper extremity and back; head and neck; thorax and abdomen; pelvis, perineum and lower extremity. 13 semester hours, first year, semester 1.

5102. Medical Histology and Cell Biology

Principles of cellular biology and a microscopic study of cells, tissues and organs. Emphasis is placed on structure-function relationships of the human body. 6 semester hours, first year, semester 1.

5103. Embryology

Principles of development of the human embryo. Emphasis is on the development of organs and organ systems. 2 semester hours, first year, semester 1.

5206. Neurobiology

Neuroanatomy, neurophysiology and neurochemistry, gross and fine structural study of the central and peripheral nervous system. Dissection of whole human brains. Coordinated lecture and laboratory program stressing normal structure and physiology of nervous system. Clinical case presentations are used to supplement classroom instruction. 5 semester hours, first year, semester 2.

DEPARTMENT OF ANESTHESIOLOGY

Paul A. Stern, chairman

Professors

Gallehugh

Stern, P.

Associate Professors

Kahn

Stern, S.

Clinical Associate Professors

Kebabjian

Kelso, E.

Clinical Assistant Professors

Leech

Sears

Stanton

Clinical Instructors

Stein

Wallace

6440. Principles of Anesthesiology

The scientific basis and fundamentals of anesthesiology are presented by lecture, seminar, demonstration and the use of audio-visual materials. Course goals are to teach the following concepts and skills with which all physicians should be familiar:

- techniques of preoperative evaluation to recognize those patients and situations that pose an increased anesthetic risk;
- preoperative therapy for such patients to minimize this risk;
- the characteristics of commonly used anesthetic agents and techniques, their risks and complications;
- the safe use of local anesthetics;
- the principles and skills involved in airway management; and
- the principles and techniques involved in the management of acute and chronic pain.

1 semester hour, second year, semester 4.

Prerequisite: Pharmacology 5316

811. Clinical Clerkship in

Anesthesiology

An elective four-week rotation in anesthesiology for qualified students at an affiliated hospital. 4 semester hours.

DEPARTMENT OF BIOCHEMISTRY

Robert W. Gracy, chairman

Professors

Gracy

Harris, B.

Jacobson, M.

Lacko

Norton

Associate Professors

Masaracchia

Pirtle

Wu

Assistant Professor

Grant

Research Professors

Dimitrijevic

Kudchodkar

Kulkarni

Rao

Sims

Srinivasan

Yüksel

Adjunct Professors

Alvarez-Gonzalez

Bollon

Cook

Jacobson, E.

Romeo, T.

5110. Principles of Biochemistry

Principles of biochemical structure and metabolism as they apply to human health and disease states. 5 semester hours, first year, semester 1.

5411. Clinical Biochemistry

A study of the biochemistry of human systems including correlative study of the clinical expression of biochemical disorders. 3 semester hours, second year, semester 4.

DEPARTMENT OF DERMATOLOGY

Paul A. Stern, acting chairman

Clinical Associate Professors

Garcia

Goetz

Clinical Assistant Professors

Cohen

Ingraham

Way

Clinical Instructor

Stoner

6564. Dermatology

Designed to provide the student with a general understanding of basic dermatology, including terminology and the diagnosis and treatment of diseases of the skin, hair and nails. 1 semester hour, third year, semester 5.

812. Clinical Clerkship in Dermatology

An elective four-week rotation in dermatology. 4 semester hours.

DEPARTMENT OF GENERAL AND FAMILY PRACTICE

Richard B. Baldwin, acting chairman

Professors

Bunnell

Richards

Urban

Associate Professors

Baldwin, R.

Carter, J.

Clark, W.

Faigin, N.

Falbey

Flanagan

Gamber

Jenkins, C.

Peterson

Zachary

Assistant Professors

Browne

Smith, G.

Whiting

Instructor*Hooper***Clinical Professors***Boyd**Carlton**Everett**Hall, R.**Kinzie**Luibel**Nobles**Saperstein**Sharp, T.***Clinical Associate Professors***Alba**Albertson**Alexander, J. M.**Angelo**Armbruster, D.**Armbruster, J.**Ayer**Baldwin, K.**Barkman**Beaty**Behrens, J.**Benderoff**Bernard**Bernstein, D.**Bernstein, S.**Beyer, D.**Bigsby**Bond**Bryant**Buckalew**Bull**Burke, J.**Burns**Burrows**Campbell**Campanile**Candelaria**Cannon**Carnicky**Carpenter, B.**Carpenter, J.**Carter, R. E.**Castoldi**Cegelski**Chambers**Chodosh**Christiansen**Cunniff**Cunningham, D.**Czewski**Daniels, R.**Darby**Davis, B.**Davis, D.**Davis, M.**Davis, S.**Dayton**DeLia**Diaz**Dowling**Doyle**Earp**Eutzler**Faigin, A.**Feinstein**Galewaler**Ganz**Garmon, A.**Gartzman**Goedecke**Goldman**Good**Haberer**Hairston**Halcomb**Hames**Hamilton**Hawa**Hayes, L.**Heaver**Henley**Hill**Hinshaw**Hoffman**Howell**Hughes**Hussey**Johnson, J.**Keilers**Kelso, G.**Kent**Kilian**Kirlin**Kludo**Kmetz**Konald**Kozura**Kramer**Kravetz**Kudelko**Leslie**Levine, K.**Lewis**Liedtke**Lindsey**Ling**Linton**Livingston**Lizerbram**Manos**Martin, L. J.**Martin, L. C.**Maul, R. G.**Maul, Rbt. G.**Mayer**Maynard**McCarty, F.**McCorckle**McKenney**McLaughlin**McLeod**Medina**Merrill**Merwin**Miller**Millington**Mims**Montgomery-Davis**Morgan, F.**Morgan, S.**Natkow**Nichols**Nolen**Norris**Nunneley**Olson**Padget**Parvin**Peden**Peyton**Phillips**Phipps**Pipes**Plattner**Poetz**Polance**Polasky**Porter**Powers**Pressley**Pruzzo**Puempel**Puryear**Quigley**Rader**Randolph**Ravin**Ray, D.**Redels**Reeves**Reich**Renna**Rhodes**Rice, E.**Rice, J.**Rocha**Roehr**Rogers**Rollins, K.**Russell**Samano**Sandknop**Sandlin**Schildberg**Scott**Sessions**Shauf**Shields, R. F.**Shields, R. J.**Shook**Sikorski**Slaughter**Smith, J. G.**Smith, J.**Smith, R.**Smola**Sowers**Spain*

Sparks, R. D.	Ward	Rollins, R.	Velasco-Segarra
Sparks, R. P.	Watkins	Rouch	Walkenhorst
Speece	Watson	Samuels	Walker, J.
Steingard	Wershaw	Sawtelle	Worrell
Stevens, W. C.	Whitham	Saylak	Wray
Stevens, W. J.	Whiting	Schmidt	Young, M.
Styduhar	Winslow	Schwartz	Zegarelli
Thomas	Wiseman	Sharp, L.	Clinical Instructors
Thompson, J. C.	Wolf	Simonak	Ansohn
Thompson, J. P.	Wolpmann	Skotnik	Beard
Tisdale	Wright, G.	Smith, B.	Guevara
Truman	Wright, J. B.	Stokes, J.	Hall, C.
Umstatt	Wright, J. L.	Strazynski	Hubner
Ungerleider	Wright, R.	Teitelbaum	Lorenz
Vasile	Young, A.	Thoreson	Noss
Villegas	Zini	Thornton	Roach
Walton			

Clinical Assistant Professors

Almy	Hulse
Apsley-Ambriz	Isbell
Behrens, K.	Johnson, E.
Beller	Johnson, H.
Bennett	Kelley
Birdwell	Keyser
Boone	Kirkdorffer
Brooks, S.	Kirkwood
Burke, A. B.	Knight
Burke, J. W. III	Kow
Cantrell	Lees
Cook, C.	Lewey
Cothorn	Lopez
Cudd	Mahoney
Davis, A.	Martin, J.
Davis, J.	Maxwell
DeLuca	Murchison
Devenport	Nelon
Eliades	Nesbit
Farrar	O'Connor
Franz	Palmer
Galarneau	Pearson, P.
Gan	Pennock
Gardner	Pettit
Garrison	Pifer
Gorman	Polk
Grayson	Pope
Griffin	Post
Haman	Probst
Hayes, R.	Reis
Hazelip	Rice, L.
Hernandez	Ridenour
Herr	Rodgers

Note: Due to space limitations only active preceptors are listed in this catalog. Please contact the Department of General and Family Practice for further information.

Division of Emergency Medicine

Richard B. Zemenick, director
Associate Professors
 Deagle
 Papa
 Zemenick
Clinical Associate Professor
 Coleridge
Clinical Assistant Professors
 Calabrese
 Schuricht
 Vinson
 White

Division of Substance Abuse

Nancy Faigin, director

701. Core Clinical Clerkship in Ambulatory Care

A required 12-week rotation in the third or fourth year. Provides the student clinical experience in family practice. Students are assigned to departmental outpatient clinics where they experience the problems of family care and continuity of care in addition to learning the patterns of patient

referral and community aspects of health care. 12 semester hours.

702. Core General Practice Junior Partnership

A required four-week rotation in ambulatory care with a general practitioner. 4 semester hours.

801. Clinical Clerkship in Ambulatory Care

An elective four-week rotation in the third or fourth year that provides students clinical experience in family practice. Students are assigned to departmental outpatient clinics where they experience the problems of family care and continuity of care in addition to learning the patterns of patient referral and the community aspects of health care. 4 semester hours.

802. General Practice Junior Partnership

An elective four-week rotation in ambulatory care. 4 semester hours.

703. Core Clinical Clerkship in Emergency Medicine

A required four-week rotation in emergency medicine. 4 semester hours.

803. Clinical Clerkship in Emergency Medicine

An elective four-week rotation in emergency medicine. 4 semester hours.

820. Clinical Clerkship in Substance Abuse

An elective four-week rotation in substance abuse. 4 semester hours.

DEPARTMENT OF MANIPULATIVE MEDICINE

Jerry Dickey, chairman

Professors

Harakal, J. H.

Korr

Richards

Associate Professors

Dickey

Gramer

Peckham

Assistant Professors

Dott, G.

Vick

Professor Emeritus

Coy

Clinical Professor

Carlton

Clinical Associate Professor

Beyer, R.

Clinical Assistant Professor

Galvas

Clinical Instructors

Samuels

Teitelbaum

The Osteopathic Clinical Practice series, which is described under the Interdisciplinary Studies section of this catalog, presents an introduction to the basic philosophy and principles of osteopathic health care. Initial emphasis is on palpatory diagnostic skills and examination for somatic dysfunction. Practical training is given in a systematic biomechanical examination of the human body. Application of the principles of manipulative treatment of somatic dysfunction is then emphasized, based on individual findings and diagnosis.

This series includes presentations of a variety of methods and activating forces to be presented simultaneously on a regional basis. The student will learn the use of direct method thrusting, direct method muscle energy, indirect method, counterstrain, and cranio-sacral. The student will be presented with a variety of methods in activating forces to treat somatic dysfunction of various regions of the body. Methods will be presented simultaneously so that a bias in treatment form is not introduced. Methods such as cranio-sacral will be presented following application of the axial and appendicular skeleton, and this will be followed by brief intensive workshops on a number of useful

adjunctive methods of treatment and their intended applications. The final section includes practical applications for various clinical entities and organ systems. Faculty and guest clinicians will present lectures and practice training sessions.

815. Clinical Clerkship in Manipulative Medicine

An elective four-week rotation for self-directed study in manipulative medicine with emphasis on application of osteopathic philosophy and principles. Primary time commitment is in the Osteopathic Manipulative Medicine Clinic. 4 semester hours.

Predoctoral Teaching Fellowship

Two students are selected each year to serve fellowships with the Department of Manipulative Medicine. The students' last two years of study are expanded to three to allow time for research, teaching and clinical service in the department.

OFFICE OF MEDICAL EDUCATION

J. Warren Anderson, chairman

Associate Professors

*Alexander**

Anderson

Barker

*Carter, B.**

Papa

Shores

Assistant Professors

*Brooks**

*Budd**

*Coffelt**

*Elam**

*McInroy-Hocevar**

*Wood**

Instructors

*Mason**

*Muirhead**

*Porter**

*Raymond**

*Taber**

Research Associate Professor

Zanecchia

Adjunct Assistant Professors

Bourdage

*Sims**

Adjunct Instructor

*McQueen**

* Serving in the Health Sciences Library or in administrative positions within the college.

9101. Computer Literacy I

Demonstrated understanding and hands-on competency in several aspects of computers, including microcomputer hardware and software, disk operating system, word processing, spreadsheets, data base management and communications software. 1 semester hour, first year, semesters 1 and/or 2.

9302. Computer Literacy II

Demonstrated understanding and hands-on competency in several medical practice-oriented computer programs. Included are programs for: practice management and billing, patient record-keeping, assistance in clinical diagnosis, management of preventive health care and on-line medical information. 1 semester hour, second year, semesters 3 and/or 4.

DEPARTMENT OF MEDICAL HUMANITIES

Clyde Gallehugh, chairman

Professors

Gallehugh

Ogilvie

Assistant Professor

Lurie

Instructors

Peyton

Rafes

The Department of Medical Humanities emphasizes the disciplines of philosophy, history, sociology, ethics, law, religion and literature as they relate to

the healing arts and to the societal and cultural factors in health and disease.

Although few courses in the humanities are formally taught, the department's aim is to incorporate issues on human values into the curriculum. Different viewpoints on medical culture, human values and their interrelationships are introduced to students through courses already being taught by other departments.

Students have the opportunity to do self-instructed and selective humanities-related study projects with approval through special consultations with the chairman.

6858. Medical Jurisprudence

Legal aspects of medical practice, including medical-legal reports, requirements for court testimony, medical malpractice and organization of a medical practice. 2 semester hours, fourth year, semester 8.

813. Clinical Clerkship in Medical Humanities

An elective four-week rotation in medical humanities. 4 semester hours.

DEPARTMENT OF MEDICINE

Michael Clearfield, chairman

Professors

Olson

Scheel

Associate Professors

Blais

Bleicher

Clearfield

Garmon

Graitzer

Gratch

Jacobson, E.

McIntosh

McKinney

Rubin

Slocum

Troutman

Assistant Professors

Fedorko

Fisher, R. G.

Foresman

Friess

Knebl

Maxvill

Ostransky

Pertusi

Weis

Wilson, W.

Wood

Instructor

Gleason-Wynn

Clinical Professor

Avery

Clinical Associate Professors

Beckwith

Hosler

Jones, M.

Locke

Meltzer

Tacka

Waddell

Wilson, J.W.

Clinical Assistant Professors

Adamo

Bode

Brenner

Childress

Cohen

Feingold

Firstenberg

Flaggman

Fling

Godell

Johnson, E.R.

Jordan

Kopman

Mills

Nophsker

Pincus

Reese

Reznick

Schneider

Skiba

Theroux

Trese

Wilkes

6442. Medicine Lecture Series

An emphasis is placed on high-impact diseases over the entire spectrum of internal medicine. Lectures cover material in the subsections of pulmonary disease, gastroenterology, neurology, infectious diseases, nephrology, rheumatology, hematology, oncology, endocrinology, immunology, cardiology, geriatrics and general medicine. Problem-solving methods, patient-oriented histories and small-group tutorials gradually are being introduced into this series. Consultation lectures from various basic science faculty members also are provided. The comprehensive nature of this course will provide students with the basic building blocks of medicine to start their own clinical experiences. 10 semester hours, second and third years, semesters 4 and 5.

704-705. Core Clinical Clerkship in Medicine

The TCOM campus clerkship is an eight-week program divided into two four-week sessions. One session is served on the general ward service at Fort Worth Osteopathic Medical Center under the guidance of TCOM Department of Medicine members. Under rigorous audit, the clerk is responsible for the care of hospitalized patients. This care includes collection of data from initial evaluation to final disposition. An emphasis is placed on the skills of problem solving (data collection), management, planning and proper record keeping (criteria of evaluations) utilizing thoroughness, reliability, efficiency and logic. Manual skills are learned and re-enforced.

The second four-week session is an ambulatory internal medicine rotation. The clerk is exposed to the multiple aspects of outpatient and ambulatory medicine including, but not limited to, rheumatology, neurology, diabetes management, general internal medicine,

geriatrics (extended-care facility visits), public health, outpatient hemodialysis and outpatient endoscopy. This session also includes case presentations and lectures on specific topics.

TCOM off-campus rotations are served at affiliated hospitals and generally are based on the classic preceptor-clerkship format. The clerk spends eight weeks in a combined ambulatory and hospital-based program that has responsibilities and goals similar to the on-campus program. 4 semester hours each.

706. Core Clinical Clerkship in Subspecialty Internal Medicine

A required four-week clerkship in subspecialty internal medicine, including one or two of the following: pulmonary medicine, gastroenterology, hematology/oncology, nephrology and rheumatology. The clerk solves problems of actual patients using those data-gathering and processing methods learned in the core medicine clerkship. Physiologic, biochemical and anatomic principles are re-examined within the framework of problem solving. 4 semester hours.

804. Clinical Clerkship in Medicine

An elective four-week rotation in medicine. 4 semester hours.

821. Clinical Clerkship in Rheumatology

An elective four-week rotation in rheumatology. 4 semester hours.

822. Clinical Clerkship in Cardiology

An elective four-week rotation in cardiology. 4 semester hours.

823. Clinical Clerkship in Endocrinology

An elective four-week rotation in endocrinology. 4 semester hours.

824. Clinical Clerkship in Gastroenterology

An elective four-week rotation in gastroenterology. 4 semester hours.

825. Clinical Clerkship in Geriatrics

An elective four-week rotation in geriatrics. 4 semester hours.

826. Clinical Clerkship in Hematology/Oncology

An elective four-week rotation in hematology/oncology. 4 semester hours.

827. Clinical Clerkship in Infectious Disease

An elective four-week rotation in infectious disease. 4 semester hours.

828. Clinical Clerkship in Nephrology

An elective four-week rotation in nephrology. 4 semester hours.

829. Clinical Clerkship in Neurology

An elective four-week rotation in neurology. 4 semester hours.

830. Clinical Clerkship in Pulmonary Medicine

An elective four-week rotation in pulmonary medicine. 4 semester hours.

831. Clinical Clerkship in Ambulatory Internal Medicine

An elective four-week rotation in ambulatory internal medicine. 4 semester hours.

DEPARTMENT OF MICROBIOLOGY AND IMMUNOLOGY

*Paul F. Cook, Chairman
Professor*

*Cook, P.
Associate Professor
Barrow
Harris, E.*

Assistant Professors

Alvarez-Gonzalez

Romeo

Research Assistant Professor

Spellman

Adjunct Assistant Professors

Daniels, E.

Grant

5213. Basic and Clinical Immunology

Natural defenses, normal immune responses, hypersensitivities and immunological diseases are presented with emphasis on principles. Clinical applications of immunology are stressed in the presentation of lectures, laboratory exercises and problem-solving case histories that are solved in small groups. Diagnostics, immunization, autoimmune disease, allergies, transplantation and cancer immunology and other clinical topics are subjects for case history studies. The fundamentals of microbiology and a survey of the characteristics of the microbial and animal parasites of man are presented. 3 semester hours, first year, semester 2.

5314. Medical Microbiology

Study of the characteristics of infectious organisms (viruses, bacteria, fungi, rickettsia and animal parasites) is followed by study of infectious diseases presented by physiological systems. Emphasis is on the dynamics of the host-parasite relationship related to disease susceptibility, pathogenesis, diagnosis, treatment and control. Special topics include medical entomology, epidemiology, nosocomial infections, chemotherapy and immunization. Lectures, laboratories, simulated patient-case presentations and problem solving are utilized. 8 semester hours, second year, semester 3.

Prerequisite: Basic and Clinical Immunology 5213.

DEPARTMENT OF OBSTETRICS AND GYNECOLOGY

Robert C. Adams, acting chairman

Associate Professor

Adams

Assistant Professors

Buchanan, S.P.

Chapman

Clinical Professor

Matthews

Clinical Associate Professors

Fischer

Hayes, V.

Clinical Assistant Professors

Guthrie

Miers

Stockburger

6547. Obstetrics

The terminology, physiology and management of normal and problem pregnancy, labor, delivery and the puerperium. 2 semester hours, second year, semester 5.

6448. Gynecology

The etiology, diagnosis and management of gynecological disorders, including infectious diseases, congenital defects and malformations, endocrinology, oncology, infertility, trauma and related problems of the female genital system. 2 semester hours, third year, semester 4.

707. Core Clinical Clerkship in Obstetrics and Gynecology

A required four-week rotation in obstetrics and gynecology. 4 semester hours.

807. Clinical Clerkship in Obstetrics and Gynecology

An elective four-week rotation in obstetrics and gynecology. 4 semester hours.

DEPARTMENT OF PATHOLOGY

Stephen L. Putthoff, chairman

Associate Professors

Peerwani

Putthoff

Wimbish

Assistant Professors

Cunningham, L.

Krouse

Sisler

6330. Pathology I

Incorporates the general fields of study known classically as basic and systemic pathology. Approach is primarily at organ levels after an introductory phase emphasizing fundamental pathophysiology. The latter encompasses processes associated with inflammation/repair, cell injury and death, infection, fluid/hemodynamic derangement and neoplasia. Subsequent systems approach illustrates major diseases and disorders encountered in the practice of medicine. Throughout, the language of medicine is emphasized as well as clinical features and differential diagnoses, where appropriate. Ultimately the student should be able to recognize, understand and predict the general effects of those pathologic processes encountered in clinical medicine. 11 semester hours, second year, semesters 3 and 4.

6331. Pathology II

This course encompasses all environmental, nutritional, toxicologic and forensic topics. These lifestyle-related diseases are core pathologic elements in modern society and merit separate and specific consideration in our curriculum. The impact of diet, substance abuse, industrial disorders and trauma of disparate types is extraordinary and will be considered comprehensively in this course. Autopsies are an integral part of Pathology II and all students will be expected to attend necropsy sessions at the Tarrant County Medical Exam-

iner's Office. An autopsy report on a participatory case is required as well. The goal of these latter activities is to correlate clinical data and the course of disease with necropsy findings. 3 semester hours, second year, semester 4.

817. Clinical Clerkship in Pathology

An elective four-week rotation in pathology. This generally includes three weeks at the Tarrant County Medical Examiner's Office with emphasis on toxicology, medical investigation, scene evaluation and forensic necropsy. An additional week is spent at the TCOM Clinical Laboratory with emphasis on laboratory data interpretation, surgical and cytopathology with double-headed microscopy, and peripheral smear/urinalysis evaluations. All pathology rotation approvals are at the discretion of the chairman of the Department of Pathology. 4 semester hours.

836. Clinical Clerkship in Toxicology

An elective four-week rotation in toxicology. Includes special case studies of clinical/forensic interest.

Institute of Forensic Medicine

The Institute of Forensic Medicine operates under the Department of Pathology, performing forensic clinical work for hospitals, physicians and medical examiners/coroners in the state, supporting research of other departments and teaching both TCOM students and UNT toxicology students.

DEPARTMENT OF PEDIATRICS

Bruce G. Gilfillan, chairman

Associate Professors

Gilfillan

Levine, A.

Assistant Professor

Blackwell

Clinical Assistant Professors

Brien

Holton

Levy

Lund

Magie

Milionis

6451. Pediatrics

Holistic approach to the newborn, infant, child and adolescent, including development and care as part of the overall approach to health. Emphasis is placed on acquiring a foundation of knowledge sufficient to provide the student with fundamentals for entering the core clinical clerkship.

Subspecialty areas include perinatology, neonatology, pediatric infectious disease, orthopedics, hematology-oncology, allergy and immunology, gastrointestinal disorders, cardiology, neurology, rheumatology, genitourinary disorders, genetic and endocrine-metabolic disorders. Pediatric physical diagnosis, accidents and poisonings, child abuse, sudden infant death and nutrition, along with growth and development, dermatology, infectious disease and emergency medicine in pediatrics are presented. 4 semester hours, second and third years, semesters 4 and 5.

708. Core Clinical Clerkship in Pediatrics

A required four-week rotation in pediatrics, general and special pediatrics, including ICU and ICU nurseries and ambulatory care in a pediatric clinic. 4 semester hours.

808. Clinical Clerkship in Pediatrics

An elective four-week rotation in pediatrics. 4 semester hours.

DEPARTMENT OF PHARMACOLOGY

Harbans Lal, chairman

Professors

Elko

Emmett-Oglesby

Lal

Lane

Associate Professors

Quist

Yorio

Assistant Professor

Forster

Adjunct Associate Professors

Petty

Schafer

Adjunct Assistant Professors

De Santis

Donahue

Meyerson

Adjunct Instructor

Hooper

5316. Medical Pharmacology

A review of fundamental principles of drug action in humans, including physiochemical principles, pharmacodynamics, pharmacokinetics and drug interactions. Common drug classes are presented, with emphasis on their principal actions, mechanisms of action, adverse reactions, contraindications and therapeutic applications. Small group problem-solving sessions, laboratory exercises, computer-assisted instructions and clinical case presentations are used to supplement classroom instruction. 8 semester hours, second year, semester 3.

DEPARTMENT OF PHYSIOLOGY

Carl E. Jones, chairman

Professors

Downey

Jones, C.

Raven

Scheel

Associate Professors

Barker

Caffrey

Gaugl

Gwirtz

Hagan

Sinclair

Assistant Professors

Barron

Kutsky

Research Assistant Professor

Gayheart

Instructor

Wilson, J. R.

Clinical Assistant Professor

Lund

Adjunct Professor

Wilson, J. E.

Adjunct Associate Professor

Squires

5206. Neurobiology

Neuroanatomy, neurophysiology and neurochemistry; gross and fine structural study of the central and peripheral nervous system. Dissection of whole human brains. Coordinated lecture and laboratory program emphasizing normal structure and physiology of nervous system. Clinical case presentations are used to supplement classroom instruction. 5 semester hours, first year, semester 2.

5207. Medical Physiology

A study of the functions of the organ systems, with emphasis placed on homeostatic control mechanisms. The major organ systems are covered, as well as additional topics on applied physiology. Problem-solving session laboratory exercises and clinical guest lectures are utilized. 9 semester hours, first year, semester 2.

Prerequisite: Biochemistry 5110 or equivalent.

DEPARTMENT OF PSYCHIATRY AND HUMAN BEHAVIOR

Harvey G. Micklin, acting chairman

Professor

Ahmed

Associate Professors

Hall

McGill
 Micklin
 Ratliff
Assistant Professor
 Gage
Clinical Associate Professor
 McKinney
Clinical Assistant Professor
 Brick
 Cox
 Furber
 Gross

6336. Principles of Psychiatry
 Emphasis on holistic and behavioral medicine, including aspects of human sexuality and dysfunction. Growth and development, adaptation, personality functioning and symptom formation are presented. Psychiatric interview techniques, mental examination, psychological testing and recognition of a variety of psychopathological conditions are covered. Includes informed use of psychotropic drugs, other somatic treatments and psychiatric emergencies. 4 semester hours, second year, semesters 3 and 4.

709. Core Clinical Clerkship in Mental Health
 A required four-week rotation in psychiatry. 4 semester hours.

809. Clinical Clerkship in Mental Health
 An elective four-week rotation in psychiatry or mental health. 4 semester hours.

DEPARTMENT OF PUBLIC HEALTH AND PREVENTIVE MEDICINE

John G. Mills, chairman
John C. Licciardone, vice chairman

Division of Health and Human Fitness
Stanley Weiss, director
Associate Professors
 Hagan

Kaman
 Mills
 Taylor, S. C.
 Weiss
 Woodworth
Assistant Professors
 Blankenship
 Licciardone

Division of Public Health and Community Medicine
Johannes C. Steenkamp, director
Associate Professor
 Steenkamp
Professor Emeritus
 Ellis
Clinical Associate Professors
 Campbell
 Taylor, B.
Clinical Assistant Professor
 Curry
 Nwanyanwu

Division of Rehabilitation/Sports Medicine
Fred Tepper, director
Associate Professor
 Tepper
Clinical Professor
 English
Clinical Assistant Professors
 Friedman
 Kristoferson
 Krupp
Adjunct Instructor
 Young, G.

The Department of Public Health and Preventive Medicine is a multidisciplinary academic unit concerned with the well-being of healthy patients and the prevention of functional loss and impairment in persons already at risk. The department has three divisions, each representing a significant aspect of the health care needs and interests of the American public. Department faculty members address these issues in Developing Dimensions in Health Care, Osteopathic Clinical Practice and other interdepartmental courses.

805. Clinical Clerkship in Public Health and Preventive Medicine

An elective four-week rotation in public health and preventive medicine.
4 semester hours.

806. Clinical Clerkship in Health and Human Fitness

An elective four-week rotation in health and human fitness. 4 semester hours.

819. Clinical Clerkship in Rehabilitation/Sports Medicine

An elective four-week rotation in rehabilitation and sports medicine.
4 semester hours.

DEPARTMENT OF RADIOLOGY

Frederick M. Wilkins, chairman

Professors

Kemplin

Wilkins

Clinical Associate Professors

Bascone

Bradley

Briney

Dott, R.

Gabier

Lancaster

Lively

Nelson

Pearson

Podolsky

Clinical Assistant Professors

Johnson, W.

Santa-Cruz

Schellin

Ventling

6571. Principles of Radiology

The study of the basic principles of diagnostic X-ray, CT scanning, ultrasound, nuclear medicine and radiation therapy; correlation of anatomy, physiology and pathology; and the clinical application of these methods of examination. 2 semester hours, third year, semester 5.

818. Clinical Clerkship in Radiology

An elective four-week rotation in radiology. 4 semester hours.

DEPARTMENT OF SURGERY

William R. Jenkins, chairman

Professors

Hawes

Jenkins

Associate Professors

Buchanan, S.W.

Tyler

Assistant Professors

McFaul

Walker, T.

Clinical Professor

Willard

Clinical Associate Professors

Calabria

Dobson

Fisher, R. B.

Glickfeld

Martz

Turner

Wakim

Clinical Assistant Professors

Beyer, D.

Brancel

Carter, R.A.

Crawford

Henwood

Hey

Hudson

Hull

Levin

McCarty, W.

Peska

Powell

Quatro

Ross

Sabater

Smith, E.

Stone

Sufian

Swords

Tuinstra

Wallace, W.

Weldon

Wilson, C.

Section of Ophthalmology

Clinical Professor

Ranelle, H.

Clinical Associate Professors

Ranelle, B.

Scadron

Van De Grift

Clinical Assistant Professor

Cundari

Section of Otorhinolaryngology

Clinical Associate Professors

Brooks

Van De Grift

Clinical Assistant Professor

Lowry

6460. Surgery Lecture Series

A basic course covering general surgery as well as thoracic and cardiovascular surgery, orthopedic surgery, urological surgery and neurosurgery. Nutritional support, critical care and basic surgical sciences also are presented. Following completion of the course, the students should be aware of common surgical problems and know the diagnostic and therapeutic regimens associated with each. Students should not only be able to correlate principles of the basic sciences to clinical conditions but also have solid foundations in the basic clinical knowledge necessary for competent patient management in their clinical rotations. The ophthalmology section is designed to give students an understanding of ocular anatomy and physiology, and their relationship to common ocular disorders; examination techniques, diagnosis and treatment methods important to family physicians are emphasized. The otorhinolaryngology-facial plastic surgery section includes clinical diagnosis and therapy of disorders of the ear, nose, paranasal sinuses and throat, bronchoesophagology, respiratory allergy and diagnosis of head and neck neoplasms, including principles of examination and the use of diagnostic instruments and screening

audiometers. 6 semester hours, second and third years, semesters 4 and 5.

710. Core Clinical Clerkship in Surgery

A required eight-week clerkship in surgery in an affiliated hospital. Students spend four weeks focusing on general surgery principles and procedures, and two weeks studying orthopedics. The remaining two weeks are spent in one of the following subspecialty areas: neurosurgery, cardiovascular/thoracic surgery, ophthalmology, otorhinolaryngology, facial plastic surgery or urology. 8 semester hours.

810. Clinical Clerkship in Surgery

An elective four-week clerkship in surgery in an affiliated hospital. 4 semester hours.

832. Clinical Clerkship in Orthopedics

An elective four-week rotation in orthopedics. 4 semester hours.

833. Clinical Clerkship in Thoracic Surgery

An elective four-week rotation in thoracic surgery. 4 semester hours.

834. Clinical Clerkship in Neurosurgery

An elective four-week rotation in neurosurgery. 4 semester hours.

835. Clinical Clerkship in Urology

An elective four-week rotation in urology. 4 semester hours.

814. Clinical Clerkship in Ophthalmology

An elective four-week rotation in ophthalmology. 4 semester hours.

816. Clinical Clerkship in Otorhinolaryngology

An elective four-week rotation in otorhinolaryngology. 4 semester hours.

INTERDISCIPLINARY STUDIES

9186. Osteopathic Clinical Practices I

The philosophy and principles of osteopathic medicine are introduced. Students explore fundamentals of osteopathic palpatory assessment and manipulative treatment. Students also learn how to interact with patients, using basic interviewing techniques, in order to obtain information concerning health problems and family histories. Students also are introduced to acute/basic life support techniques. 5 semester hours, first year, semester 1.

9191. Developing Dimensions in Health Care I

An introduction to processes and procedures influencing health care delivery on community and individual levels, including economic and socio-cultural influences. Shifts in health care toward health promotion and disease prevention and the functions of other health-related disciplines in the coordinated delivery of comprehensive care are presented. Students participate in a series of workshops chosen from a large variety of topics such as hypnosis, tobacco dependency and stress management. Coordination is provided by the Department of Public Health and Preventive Medicine. 3 semester hours, first year, semester 1.

9287. Osteopathic Clinical Practices II

Students continue physical assessment of the patient through physical examination and osteopathic palpatory assessment correlated by major organ systems wherever possible. Lectures are coupled with practice training sessions. In many sessions students interact with simulated patients in the context of physical data collection. Clinical problems are periodically integrated with the normal findings. The osteopathic assessment begun in OCP 9186 continues to address treatment through the refinement of soft tissue

and muscle energy skills. 8 semester hours, first year, semester 2.

9292. Developing Dimensions in Health Care II

A continuation of 9191 with additional emphasis on the basics of nutrition and the influence of nutrition on health and disease processes. Coordination is provided by the Department of Public Health and Preventive Medicine. 3 semester hours, first year, semester 2.

9388. Osteopathic Clinical Practices III

A continuation of the OCP course series. During 9186 and 9287, students were introduced to the normal findings of physical assessment. During OCP 9388 students begin the study of common abnormal findings. Lectures on physical diagnosis and manipulative medicine are coupled with laboratories and practice training sessions. Students also complete assignments with a community-based physician and at community health care facilities. Emphasis in 9388 is on H&P interviewing and recording, skin, HEENT, respiratory system, cardiovascular system and the gastrointestinal system. 6 semester hours, second year, semester 3.

9393. Developing Dimensions in Health Care III

A lecture series in preventive medicine and community health. Major content areas include communicable disease control, environmental health, occupational medicine, epidemiology and biostatistics. Students also participate in a series of health care workshops designed to provide additional insight and practical experience in selected areas of personal interest. Coordination is provided by the Department of Public Health and Preventive Medicine. 3 semester hours, second year, semester 3.

9494. Developing Dimensions in Health Care IV

Biomedical Ethics - A required weekly discussion on major ethical issues in health care. Coordination is provided by the faculty of the Department of Medical Humanities. 1 semester hour, second year, semester 4.

Medical Jurisprudence - Legal aspects of medical practice, including medical-legal reports, requirements for court testimony, medical malpractice and organization of a medical practice. Coordination is provided by the faculty of the Department of Medical Humanities. 2 semester hours, second year, semester 4.

9489. Osteopathic Clinical Practices IV

A continuation of the OCP course series. Emphasis in 9489 is on the reproductive system, the musculoskeletal and nervous system, and the integration of clinical nutrition and patient education in each patient encounter. In the last weeks of this course the student is expected to demonstrate competence in completing a full H&P on both pediatric- and geriatric-simulated patients. 8 semester hours, second year, semester 4.

9580. Sociocultural Impacts on Health Care

A required weekly panel discussion of social and cultural aspects of patient care and application of these concepts to practice in different populations. Coordination is provided by the faculty of the Department of Medical Humanities. 1 semester hour, third year, semester 5.

9584. Clinical Problem Solving (elective)

In this course, taught jointly by the clinical faculty, students learn a core of problem-solving behavior: how to gather and sift data, develop problem lists and generate management plans.

Students are randomly assigned to tutorial groups that encourage independent study as well as foster development of those teamwork skills necessary in medical practice. Each tutorial group approaches a series of patient problems. The members of the group collaborate in data gathering and sifting. They then review data and select the best available resources from which to learn the appropriate medical content for a competent solution to the patient's problems. Sharing this information, they work together in drafting a high-quality management plan for each problem. The students learn to access an information bank with thoroughness, accuracy and efficiency. In this problem-solving format, students learn the lifetime skill of teaching themselves medicine. 1 semester hour, third year, semester 5.

9685. Directed Studies (elective)

Individual program of special studies, arranged with any academic department.

9883. ACLS Certification

An intensive presentation following American Heart Association guidelines for Advanced Cardiac Life Support is presented to fourth-year students with the intention of their gaining national AHA certification. Coordination is provided by faculty from the Division of Emergency Medicine. 1 semester hour, fourth year, semester 8.

OTHER GRADUATE DEGREE PROGRAMS

T COM faculty members participate in both master of science and doctor of philosophy degree programs in several basic science areas for non-medical students through the University of North Texas Graduate School.

The M.S. program normally involves the UNT Department of Biomedical Sciences, and students are encouraged

to contact the UNT department chairman's office for details. The Ph.D. programs are offered through the appropriate doctoral degree-granting department at UNT, including biochemistry, biological sciences and psychology, or the Federation of North Texas Area Universities' program in molecular biology. For details, consult the UNT Graduate Bulletin as well as the appropriate department at TCOM.

Financial support may be available through private foundations as well as through state and federally supported grant funds that have been awarded to the faculty.

Joint M.S./D.O. Program

Selected TCOM students who seek the M.S. degree concurrently with the D.O. degree may use summer sessions as well as optional clinical rotations for the necessary graduate course work and thesis research. Alternatively, the student may petition TCOM's vice president for academic affairs and dean for a withdrawal at an appropriate time in the medical curriculum to complete requirements for the M.S. degree. The withdrawal would normally follow completion of the basic science courses in the medical program. A maximum of six semester hours of acceptable transfer graduate course work from another institution may be applied to the degree plan.

The TCOM/UNT program is interdisciplinary, with the degree plan individually designed for the specific needs of the student. The degree, conferred by UNT, is available with concentrations in anatomy, biochemistry, microbiology and immunology, pharmacology, toxicology and physiology.

The degree requires the following: (1) satisfactory completion of the first two years of course work at TCOM; (2) a minimum of 18 semester hours of graduate-level course work through UNT, including a six-hour thesis; and (3) approval of the student's advisory

committee and the UNT Graduate School dean.

Prospective students must contact UNT's Department of Biomedical Sciences chairman during the early planning stages about specific requirements in each of the divisions.

Joint Ph.D./D.O. Program

A limited number of students who have been accepted by the TCOM Admissions Committee may be permitted to pursue a joint doctoral degree program. This effort could ultimately result in the awarding of both the D.O. degree through TCOM and the Ph.D. degree through UNT. Acceptance in the joint program requires the approval of the vice president for academic affairs and dean of TCOM and the dean of the UNT Graduate School as well as acceptance into the doctoral program by the appropriate UNT department.

A joint doctoral degree will permit the individual to actively pursue a career in research and/or academic medicine. The joint training programs will introduce the student doctor to modern research techniques and methodologies, which should reinforce a basic understanding of clinical techniques and procedures. Such a combination would permit the student to carry out fundamental research programs in clinically relevant areas.

The program normally will involve the student doctor successfully completing the basic science courses in the medical curriculum, then accepting a withdrawal from TCOM to complete additional graduate course requirements and the dissertation research for the Ph.D. A maximum of 24 semester hours, post M.S. degree, of acceptable transfer graduate course work from another institution may be applied to the degree plan. Upon satisfactory completion of graduate study, the student would then re-enter the medical program at the appropriate level and complete the clinical requirements for the D.O. degree.

TCOM students interested in the joint Ph.D./D.O. program should contact the associate dean for basic sciences at TCOM and the graduate dean at UNT early in the planning stages. Graduate course work and dissertation research may be carried out on the TCOM campus in Fort Worth and/or the UNT campus in Denton.

POSTGRADUATE PROGRAMS

Medical/Basic Science Study

Individuals who have earned the D.O. degree and who may be interested in pursuing the Ph.D. degree should contact the UNT Graduate School dean for further information.

Consult the UNT Graduate Bulletin for details on all joint graduate programs.

Residency Program in Anesthesiology

TCOM offers an American Osteopathic Association-approved residency program for training qualified osteopathic physicians in the practice of anesthesiology, as defined by the American Osteopathic Board of Anesthesiology. The practice of anesthesiology is defined as consisting of and including that branch of medical science, art and practice that deals with the use of anesthetic agents and the care of complications incident to their use.

The TCOM program provides the educational requirements to qualify the resident for membership in the American Osteopathic College of Anesthesiologists and for eventual examination by the American Osteopathic Board of Anesthesiology pursuant to certification in anesthesiology.

Residency Program in General and Family Practice

TCOM offers an American Osteopathic Association-approved residency program for training qualified osteopathic physicians in general practice.

The TCOM program is associated with the affiliated hospitals. Effective July 1, 1988, it is a three-year program that includes a rotating internship as the first year of the residency. The program provides the educational requirements to qualify residents for membership in the American College of Osteopathic General Practitioners and for eventual examination by the American Board of Osteopathic General Practitioners to pursue certification in general practice.

Residency Program in General Internal Medicine

TCOM offers an American Osteopathic Association-approved residency program for training qualified osteopathic physicians in the practice of general internal medicine.

The TCOM program provides the educational requirements to qualify the resident for membership in the American College of Osteopathic Internists and for eventual examination by the American College of Osteopathic Internists pursuant to certification in general internal medicine.

Residency Program in Obstetrics/Gynecology

TCOM offers an American Osteopathic Association-approved residency program for training qualified osteopathic physicians in the practice of obstetrics and gynecology.

The TCOM program provides the education requirements to qualify the resident for membership in the American College of Osteopathic Obstetricians and Gynecologists and for eventual examination by the American Osteopathic Board of Obstetrics and Gynecology pursuant to certification in Obstetrics and Gynecology.

Residency Program in Surgery

TCOM offers an American Osteopathic Association-approved residency

program for training qualified osteopathic physicians in the practice of general surgery.

The TCOM program provides the educational requirements to qualify the resident for membership in the American College of Osteopathic Surgeons and for eventual examination by the American Osteopathic Board of Surgery pursuant to certification in surgery.

Residency Program in Urology

TCOM offers an American Osteopathic Association-approved residency program for training qualified osteopathic physicians in the practice of urology.

The TCOM program provides the educational requirements to qualify the resident for membership in the American College of Osteopathic Surgeons (Urology) and for eventual examination by the American Osteopathic Board of Surgery pursuant to certification in Urology.

ONE

TWO

THREE

FOUR

FIVE

Student Affairs

SIX

INDEX

*Office of Student Affairs
Student Activities
Honors and Awards
Scheduling Events
Military Affairs*



OFFICE OF STUDENT AFFAIRS

The Office of Student Affairs provides assistance to students from the time they apply for admission to TCOM through matriculation to graduation so as to facilitate their academic training, personal growth and development.

This office assists the president of the college in interpreting student needs, in creating an atmosphere that stimulates learning and in integrating extracurricular experiences into the formal learning programs.

The goals of this office are to encourage student participation in and contribution to the total college program, to establish and coordinate a system of

student academic advisement, and to interpret college regulations on academic and non-academic matters to students. The Office of Student Affairs includes admissions, academic assistance, financial aid and the registrar.

Guidance, Counseling and Academic Advisement

Guidance involves the collection and dissemination of information regarding students' needs and interests. Student forums are scheduled with each class at various times during the academic year to provide opportunities for students, administration, faculty and staff to discuss areas of interest and concern. An orientation program is scheduled each fall to provide freshmen with an

opportunity to meet their classmates, faculty and administration in a non-classroom situation, and to provide information and details about important aspects of the curriculum and the college.

Counseling referrals for discussion of academic or personal problems are available through the Office of Student Affairs for students and spouses by appointment and on a walk-in basis. Group counseling sessions may be scheduled throughout the year and are open to all students and spouses.

Academic advisement services also are available by appointment or on a walk-in basis. These services include counseling in learning-skills effectiveness, time management, test-taking skills and a tutorial program. The Office of Student Affairs works closely with both preclinical and clinical sciences faculty and the Office of Academic Affairs to provide direction and support in periods of academic difficulty, to plan alternate programs and to assist in reassessment of priorities.

ID Cards

TCOM identification cards are issued during fall registration.

Housing

TCOM does not have student housing available. Students are responsible for making their own living arrangements.

Health Services

TCOM students and their dependents may use, by appointment, the health-care services of the Central Family Practice Clinic in Medical Education Building 1 at no charge, except for laboratory procedures and drugs (on a cost basis). Insurance claims will be filed. Referrals to specialty areas will be made as needed through the Central Family Practice Clinic on the same basis.

All students are expected to provide for their own health-care coverage while attending TCOM. More information is available from the Office for Student Affairs.

Food Service

Food is available from vending machines in the TCOM academic buildings and the Activities Center, and a number of restaurants are within walking distance of the campus.

STUDENT ACTIVITIES

Sports

Recreational activities at TCOM are available in the Activities Center as well as through softball, basketball and volleyball teams.

Organizations

Students may participate in a variety of organizations, which include (but are not limited to):

- American Osteopathic Association
- Atlas Club, professional fraternity
- Baha'i Club
- Black Medical Student Organization
- Christian Medical Society
- Delta Omega, national osteopathic organization for women physicians
- Emergency Medicine Association
- Mexican-American Medical Student Organization
- Phi Beta Pi, national social medical fraternity
- Psi Sigma Alpha, national osteopathic honor society
- Society for the Advancement of Osteopathic Medicine
- Student Chapter of the American College of General Practitioners in Osteopathic Medicine and Surgery
- Student Government Association
- Speculum (yearbook)
- Student Associate Auxiliary
- Student Osteopathic Medical Association
- Undergraduate American Academy of Osteopathy

- Undergraduate Academy of Sports Medicine

HONORS AND AWARDS

Each year students are either selected or elected to receive numerous honors and awards in the areas of academic performance, research and service to the community and the profession. More information is available from the Office of Student Affairs.

SCHEDULING EVENTS

Student organizations may schedule extracurricular seminars, programs and guest lectures. Such activities must be scheduled with the Office of Student Affairs. Reservation forms are then submitted to the Special Events Coordinator of the college for official approval and facilities scheduling.

MILITARY AFFAIRS

TCOM is approved by the Texas Education Agency for the training of men and women who have served in the armed forces. Assistance is provided to students who are on active duty or who are veterans. To establish eligibility for assistance, a veteran should contact the Office of the Registrar for the appropriate forms. The completed forms and a copy of Form DD-214 should be forwarded to the Office of the Registrar.

Veterans wishing to continue their benefits at TCOM should complete a Transfer of Training Application and submit it to the registrar. A student must maintain a minimum cumulative weighted average of 70 to remain eligible to receive veteran's benefits. Veteran's benefit payments may not be made during any period of academic probation.

ONE

TWO

THREE

FOUR

FIVE

SIX

Faculty

INDEX

Faculty

Emeritus Faculty

Professional Library Staff

Clinical/Adjunct Faculty



FACULTY*

Adams, Robert C., D.O.

Associate Professor and Acting Chairman,
Obstetrics and Gynecology;
B.S. Northeast Missouri State University,
D.O. Kirksville College of Osteopathic
Medicine

Ahmed, Bashir, M.D.

Professor, Psychiatry and Human Behavior;
B.S. Osmania University,
M.D. Karachi University

Alexander, Jerry, Ph.D.

Associate Professor, Medical Education;
B.S. Pennsylvania State University,
M.Ed. and Ph.D. University of Southern
Mississippi

Alvarez-Gonzalez, Rafael, Ph.D.

Assistant Professor, Microbiology and
Immunology;
B.S. Universidad de Michoacan,
M.S. and Ph.D. University of North Texas

Anderson, J. Warren, Ed.D.

Associate Professor and Associate Dean,
Medical Education;
Executive Assistant to the President;
B.S. Iowa State University,
M.S. San Diego State University,
Ed.D. Indiana University

Aschenbrenner, John E., Ph.D.

Associate Professor, Anatomy;
B.S. Iona College,
M.S. Rutgers University,
Ph.D. Baylor University

*as of June 1, 1989

Baldwin, Richard B., D.O.
Associate Professor, General and Family
Practice;

B.S. University of Oklahoma,
D.O. University of Health Sciences

Barker, David J., Ph.D.
Associate Professor, Medical Education;
Associate Professor, Physiology;
B.A. Hofstra University,
M.A. and Ph.D. University of Illinois

Barron, Barbara, Ph.D.
Assistant Professor, Physiology;
B.S. Creighton University College of
Pharmacy,
Ph.D. University of Nebraska Medical
Center

Barrow, William Wesley, Ph.D.
Associate Professor, Microbiology and
Immunology;

B.S. Midwestern State University,
M.S. University of Houston,
Ph.D. Colorado State University

Blackwell, Deborah L., D.O.
Assistant Professor, Pediatrics;
B.A. University of Texas at Austin,
D.O. Texas College of Osteopathic
Medicine

Blais, Francis X., D.O.
Associate Professor, Medicine;
B.A. Northeastern University,
D.O. Philadelphia College of Osteopathic
Medicine

Blankenship, Ann, Ph.D., R.D., L.D.
Assistant Professor, Public Health and
Preventive Medicine (Health and Human
Fitness)

B.S. Texas Christian University,
M.S. and Ph.D. Texas Woman's University

Bleicher, Jeff, D.O.
Associate Professor, Medicine;
B.S. Muhlenberg College,
D.O. University of Osteopathic Medicine
and Health Sciences

Bourdage, Robert J., Ph.D.
Assistant Professor, Anatomy;
B.A. and Ph.D. University of Washington

Browne, Carol S., D.O.
Assistant Professor, General and Family
Practice;

B.A. Southwestern University,
D.O. Texas College of Osteopathic
Medicine

Buchanan, Sam W., D.O.
Associate Professor, Surgery;
B.S. Texas Christian University,

D.O. Texas College of Osteopathic
Medicine

Buchanan, Steve P., D.O.
Assistant Professor, Obstetrics and
Gynecology;

B.S. University of Texas at Arlington,
D.O. Texas College of Osteopathic
Medicine

Budd, M. L., Ph.D.
Assistant Professor, Medical Education;
B.A. Albion College,
M.S. University of Michigan,

Ph.D. Michigan State University
Bunnell, Larry L., D.O., F.A.C.G.P.
Professor and Chairman, General and
Family Practice;

B.S. Ohio State University,
D.O. Kirksville College of Osteopathic
Medicine

Caffrey, James L., Ph.D.
Associate Professor, Physiology;
A.B. Rutgers University,
Ph.D. University of Virginia

Cammarata, Patrick R., Ph.D.
Assistant Professor, Anatomy;
B.S. State University of New York at
Stony Brook,
Ph.D. Hunter College, City University of
New York

Carnes, James E., Ph.D.
Associate Professor, Anatomy;
B.A. Baylor University,
B.S. University of Texas at Arlington,
M.A. and Ph.D. University of North Texas

Carter, John E., Jr., D.O., F.A.C.G.P.
Associate Professor, General and Family
Practice;

B.S. Wayne State University,
D.O. Chicago College of Osteopathic
Medicine

Chapman, John M., D.O., F.A.C.O.G.
Assistant Professor, Obstetrics and
Gynecology;
B.S. Northeast Missouri State University,
D.O. Kirksville College of Osteopathic
Medicine

Clark, William H., Jr., D.O.
Associate Professor, General and Family
Practice;

B.S. Baylor University,
D.O. University of Health Sciences
Clearfield, Michael B., D.O., F.A.C.O.I.
Associate Professor and Chairman,
Medicine;

B.S. Albright College,

D.O. Chicago College of Osteopathic
Medicine

Coffelt, Ken

Assistant Professor, Medical Education;
Assistant Vice President for Administrative
Affairs;

B.S. and M.S. University of Oklahoma

Cook, Paul F., Ph.D.

Professor and Chairman, Microbiology and
Immunology;

B.A. Our Lady of the Lake College,

Ph.D. University of California at Riverside

Cunningham, Linda F., M.D.

Assistant Professor, Pathology;

B.S. University of Alabama,

M.D. Vanderbilt University

Deagle, John H., Ph.D., D.O.

Associate Professor, General and Family
Practice (Emergency Medicine);

B.S. Rensselaer Polytechnic Institute,

Ph.D. University of Tennessee,

D.O. University of Osteopathic Medicine
and Health Sciences

Dickey, Jerry, D.O.

Associate Professor and Chairman, Ma-
nipulative Medicine;

B.S. Texas Wesleyan College,

D.O. Kirksville College of Osteopathic
Medicine

Dimitrijevic, Slobodan D., Ph.D.

Research Professor, Biochemistry;

B.S. and Ph.D. University of Bath

Dott, Gregory A., D.O.

Assistant Professor, Manipulative
Medicine;

B.S. Texas Lutheran College,

D.O. Texas College of Osteopathic
Medicine

Downey, H. Fred, Ph.D.

Professor, Physiology;

B.S. and M.S. University of Maryland,

Ph.D. University of Illinois at Urbana-
Champaign

Dzandu, James K., Ph.D.

Assistant Professor, Anatomy;

B.S. and M.S. University of Ghana,

Ph.D. Wayne State University

Elko, Edward E., Ph.D.

Professor, Pharmacology;

B.S. University of Scranton,

Ph.D. University of Tennessee Medical
Units

Emmett-Oglesby, Michael, Ph.D.

Professor, Pharmacology;

B.A. University of Chicago,

Ph.D. State University of New York
at Buffalo

Faigin, Nancy, D.O.

Associate Professor, General and Family
Practice (Substance Abuse);

Director, Substance Abuse Division;

B.S. Texas Wesleyan College,

D.O. University of Health Sciences

Falbey, Frank B., D.O.

Associate Professor, General and Family
Practice;

D.O. Philadelphia College of Osteopathic
Medicine

Fedorko, Steve, Ph.D.

Assistant Professor, Medicine;

B.A., M.A. and Ph.D. University of Texas
at Arlington

Fisher, Russell G., D.O.

Assistant Professor, Medicine;

B.S. St. John's University of New York,

D.O. Philadelphia College of Osteopathic
Medicine

Flanagan, Gerald P., D.O., F.A.C.G.P.

Associate Professor, General and Family
Practice;

D.O. University of Health Sciences

Foresman, Brian H., D.O.

Assistant Professor, Medicine;

B.S. and D.O. Michigan State University

Forster, Michael J., Ph.D.

Assistant Professor,
Pharmacology;

B.A. Muhlenberg College,

M.A. and Ph.D. Bowling Green State
University

Frless, Gregory G., D.O., F.A.C.P.

Assistant Professor, Medicine;

B.S. University of Texas at Arlington,

D.O. Texas College of Osteopathic
Medicine

Gage, Gloria A., D.O.

Assistant Professor, Psychiatry and Human
Behavior;

D.O. Texas College of Osteopathic
Medicine

Gallehugh, Clyde, D.O., F.A.O.C.A.

Professor, Anesthesiology;

Professor and Chairman, Medical
Humanities;

B.S. University of Kansas,

D.O. University of Health Sciences

Gamber, Russell G., D.O.

Associate Professor, General and Family
Practice;

Assistant Director, Center for Osteopathic Research and Education;

B.A. West Virginia University,
D.O. Kirksville College of Osteopathic Medicine

Garmon, Robert, D.O., F.A.C.C.P., F.A.C.O.I.

Associate Professor, Medicine;
B.S. West Texas State University,
D.O. Kirksville College of Osteopathic Medicine

Gaugl, John F., Ph.D.

Associate Professor, Physiology;
B.A. and M.A. University of North Texas,
Ph.D. University of California at Berkeley

Gayheart, Pamela, Ph.D.

Research Assistant Professor, Physiology;
B.A. University of North Carolina,
Ph.D. Bowman Gray School of Medicine,
Wake Forest University

Gilfillan, Bruce G., D.O.

Associate Professor and Chairman,
Pediatrics;
B.A. University of Pennsylvania,
D.O. Philadelphia College of Osteopathic Medicine

Gleason-Wynn, Patricia E.

Instructor, Medicine;
B.S. Niagra University,
M.S. University of Texas at Arlington

Gracy, Robert W., Ph.D.

Professor and Chairman, Biochemistry;
B.S. California State Polytechnic University,

Ph.D. University of California at Riverside

Graitzer, Howard, D.O., F.A.C.O.I.

Associate Professor, Medicine;
B.S. Pennsylvania State University,
D.O. Philadelphia College of Osteopathic Medicine

Gramer, Jack H., D.O., F.A.A.O.

Associate Professor, Manipulative Medicine;

B.S. Texas Wesleyan College,
D.O. University of Health Sciences

Grant, Stephen R., Ph.D.

Assistant Professor, Biochemistry;
B.A. Westmar College
M.S. and Ph.D. University of Tennessee

Gratch, Jack O., D.O.

Associate Professor, Medicine;
B.S. Philadelphia College of Pharmacy and Science,
D.O. Philadelphia College of Osteopathic Medicine

Gwartz, Patricia A., Ph.D.

Associate Professor, Physiology,
B.S. Drexel University,
Ph.D. Thomas Jefferson University

Hagan, R. Donald, Ph.D.

Associate Professor, Public Health and Preventive Medicine (Health and Human Fitness);

Associate Professor, Physiology;
B.A. California State University at Northridge,

M.A. University of California at Santa Barbara,

Ph.D. University of Oregon

Hall, James R., Ph.D.

Associate Professor, Psychiatry and Human Behavior;

B.A. University of Iowa,
Ph.D. University of Nevada at Reno

Harakal, John H., D.O., F.A.A.O.

Professor, Manipulative Medicine;
B.S. Bowling Green State University,
D.O. Kirksville College of Osteopathic Medicine

Harris, Ben G., Ph.D.

Professor, Biochemistry;
Associate Dean, Research;
B.S. Southwestern Oklahoma State University,

M.S. and Ph.D. Oklahoma State University

Harris, Elizabeth F., Ph.D.

Associate Professor, Microbiology and Immunology;

B.A. Texas Wesleyan College,
M.A. Texas Christian University,

Ph.D. University of Texas Southwestern Medical Center at Dallas

Hawes, Charles M., D.O., F.A.C.O.S., F.A.O.A.O.

Professor, Surgery;
D.O. Kirksville College of Osteopathic Medicine

Hooper, C. Dan

Instructor, General and Family Practice;
B.S. University of Oklahoma

Jackson, Fredrick L., Ph.D.

Assistant Professor, Anatomy;
B.S. University of Wyoming,
Ph.D. University of Texas Health Science Center at Houston

Jacobson, Elaine, Ph.D.

Associate Professor, Medicine;
B.S. and Ph.D. Kansas State University

Jacobson, Myron K., Ph.D.

Professor, Biochemistry;

B.S. University of Wisconsin at Platteville,
Ph.D. Kansas State University
Jenkins, Constance I., D.O.

Associate Professor, General and Family
Practice;
D.O. Kirksville College of Osteopathic
Medicine

Jenkins, William R., D.O., F.A.C.O.S.
Professor and Chairman, Surgery;
B.S. Texas Wesleyan College,
D.O. Kirksville College of Osteopathic
Medicine

Jones, Carl E., Ph.D.
Professor and Chairman, Physiology;
Associate Dean, Basic Sciences;
B.S. William Carey College,
Ph.D. University of Mississippi School of
Medicine

Kahn, Hyman, D.O., F.A.O.C.A.
Associate Professor, Anesthesiology;
D.O. Kirksville College of Osteopathic
Medicine

Kaman, Robert L., Ph.D.
Associate Professor, Public Health and
Preventive Medicine (Health and Human
Fitness);
A.B. University of Pennsylvania,
M.S. and Ph.D. Virginia Polytechnic
Institute

Kemplin, John C., D.O.
Professor, Radiology;
B.S. and M.S. University of North Texas,
D.O. Kirksville College of Osteopathic
Medicine

Knebl, Janice A., D.O.
Assistant Professor, Medicine;
B.S. St. Joseph's University
D.O. Philadelphia College of Osteopathic
Medicine

Korr, Irvin M., Ph.D.
Professor, Manipulative Medicine;
B.A. and M.A. University of Pennsylvania,
Ph.D. Princeton University

Krouse, Marc Andrew, M.D.
Assistant Professor, Pathology;
B.S. Texas A&M University,
M.D. University of Texas Southwestern
Medical Center at Dallas

Kudchodkar, B. J., Ph.D.
Research Professor, Biochemistry;
B.S. University of Bombay,
M.S. University of Punjab,
M.S. and Ph.D. University of Saskatchewan

Kulkarni, Gopal, Ph.D.
Research Professor, Biochemistry;

B.S. Karnatak University,
Ph.D. Indian Institute of Science
Kutsky, Phyllis, Ph.D.
Assistant Professor, Physiology;
A.B. Oberlin College,
M.A. University of Texas Southwestern
Medical Center at Dallas,
Ph.D. University of California at Berkeley
Lacko, Andras G., Ph.D.

Professor, Biochemistry;
B.S.A. and M.S. University of British
Columbia,
Ph.D. University of Washington
Lal, Harbans, Ph.D., F.A.C.C.P.
Professor and Chairman, Pharmacology;
B.S. Punjab University,
M.S. University of Kansas,
Ph.D. University of Chicago
Lane, John D., Ph.D.

Professor, Pharmacology;
B.A. Indiana University,
Ph.D. Indiana University School of
Medicine

Levine, Alan, D.O.
Associate Professor, Pediatrics;
B.S. Drexel University,
D.O. Philadelphia College of Osteopathic
Medicine

Licciardone, John C., D.O.
Vice Chairman and Assistant Professor,
Public Health and Preventive Medicine
(Health and Human Fitness);
B.S. Fordham University,
M.S. Ohio State University College of
Medicine,
D.O. Kirksville College of Osteopathic
Medicine

Lieska, Norman G., Ph.D.
Assistant Professor, Anatomy;
B.S. University of Michigan,
Ph.D. Wayne State University

Lurie, Sue G., Ph.D.
Assistant Professor, Medical Humanities;
B.A. University of South Carolina,
M.A. University of North Carolina,
Ph.D. University of Oklahoma

Masaracchia, Ruthann A., Ph.D.
Associate Professor, Biochemistry;
B.A. Park College,
M.S. and Ph.D. University of Massachusetts
Maxvill, Charles T., D.O.

Assistant Professor, Medicine
B.S. Southern Methodist University,
D.O. Chicago College of Osteopathic
Medicine

McFaul, Robert B., D.O.
 Assistant Professor, Surgery;
 B.A. Texas Tech University,
 D.O. Texas College of Osteopathic
 Medicine

McGill, Jerry C., Ph.D.
 Associate Professor, Psychiatry and Human
 Behavior;
 B.A. Hardin-Simmons University,
 M.A. Texas Tech University
 Ph.D. University of North Texas

McIntosh, William E., D.O.
 Associate Professor, Medicine;
 B.A. University of Cincinnati,
 D.O. University of Osteopathic Medicine
 and Health Sciences

McKinney, Mark Eric, Ph.D.
 Associate Professor, Medicine
 B.A. and Ph.D. University of Texas
 at Arlington

Micklin, Harvey G., D.O.
 Associate Professor and Acting Chairman,
 Psychiatry and Human Behavior;
 B.S. Brooklyn College of Pharmacy,
 D.O. University of Osteopathic Medicine
 and Health Sciences

Mills, John G., D.O., M.P.H.
 Associate Professor and Chairman,
 Public Health and Preventive Medicine
 (Health and Human Fitness);
 B.S., M.S. and D.O. Michigan State
 University
 M.P.H. University of Michigan

Norton, S. J., Ph.D.
 Professor, Biochemistry;
 B.S. Abilene Christian University,
 Ph.D. University of Texas at Austin

**Ogilvie, Charles D., D.O., F.A.O.C.R.,
 F.A.C.O.S.**
 Professor, Medical Humanities;
 D.O. Kirksville College of Osteopathic
 Medicine

Olson, C. Raymond, D.O., F.A.C.O.I.
 Professor, Medicine;
 B.A. Oberlin College,
 D.O. Chicago College of Osteopathic
 Medicine

Orr, Edward L., Ph.D.
 Associate Professor, Anatomy;
 B.S. Cleveland State University,
 Ph.D. University of California at Berkeley

Ostransky, David, D.O.
 Assistant Professor, Medicine;
 B.S. Wright State University,

D.O. Kirksville College of Osteopathic
 Medicine

Papa, Frank J., D.O.
 Associate Professor, General and Family
 Practice (Emergency Medicine);
 Associate Professor, Medical Education;
 B.A. La Salle College,
 D.O. Philadelphia College of Osteopathic
 Medicine

Peckham, John R., D.O.
 Associate Professor, Manipulative Medi-
 cine; Director, Center for Osteopathic
 Research and Education;
 Associate Dean, General Medicine;
 D.O. Kirksville College of Osteopathic
 Medicine

Peerwani, Nizam, M.D.
 Associate Professor, Pathology;
 B.S. and M.D. American University
 of Beirut

Pertusi, Raymond M., D.O.
 Assistant Professor, Medicine;
 B.A. New York University,
 D.O. New York College of Osteopathic
 Medicine

Peterson, Donald, D.O., F.A.C.G.P.
 Associate Professor, General and Family
 Practice;
 B.B.A. University of North Texas,
 D.O. University of Health Sciences

Peyton, Sarah A.
 Instructor, Medical Humanities;
 B.A. Colorado Women's College,
 M.S.S.W. University of Texas at Arlington

Pirtle, Robert M., Ph.D.
 Associate Professor, Biochemistry;
 B.S. Georgia Institute of Technology,
 Ph.D. University of Louisville

Putthoff, Stephen L., D.O.
 Associate Professor and Chairman,
 Pathology;
 B.S. University of Missouri,
 D.O. University of Health Sciences

Quist, Eugene E. Ph.D.
 Associate Professor, Pharmacology;
 B.S. and Ph.D. University of British
 Columbia

Rafes, Richard S., J.D.
 Instructor, Medical Humanities;
 B.S. Lamar University,
 J.D. University of Houston

Rao, G. S. J., Ph.D.
 Research Professor, Biochemistry;
 B.S. and M.S. Bangalore University,
 Ph.D. Indian Institute of Science

Ratliff, Randall, Ph.D.

Associate Professor, Psychiatry and Human Behavior;

B.S. and M.S. University of North Texas,
Ph.D. East Texas State University

Raven, Peter B., Ph.D.

Professor, Physiology;

B.S., M.S. and Ph.D. University of Oregon

Richards, David M., D.O., F.A.C.G.P.

Professor, General and Family Practice;

Professor, Manipulative Medicine;

President;

B.A. Baldwin Wallace College,

D.O. Kirksville College of Osteopathic
Medicine

Romeo, Tony, Ph.D.

Assistant Professor, Microbiology and
Immunology;

B.S., M.S. and Ph.D. University of Florida

Rubin, Bernard, D.O.

Associate Professor, Medicine;

B.S. University of Illinois at Urbana-
Champaign,

D.O. Chicago College of Osteopathic
Medicine

Rudick, Victoria, Ph.D.

Associate Professor, Anatomy;

B.A. College of Wooster,

Ph.D. Ohio State University

Scheel, Konrad W., Ph.D.

Professor, Physiology;

Professor, Medicine;

B.S. Tulane University,

Ph.D. University of Mississippi School
of Medicine

Schunder, Mary, Ph.D.

Associate Professor, Anatomy;

Associate Dean, Student Affairs;

B.A. and M.A. Texas Christian University,

Ph.D. Baylor University

Shores, Jay H., Ph.D.

Associate Professor, Medical Education;

Acting Director, Faculty and Curriculum
Development;

B.S. and M.Ed. University of Illinois at

Urbana-Champaign,

Ph.D. University of Wisconsin

Sims, James L., Ph.D.

Research Professor, Biochemistry;

B.A. Austin College,

Ph.D. University of North Texas

Sinclair, Richard J., Ph.D.

Associate Professor, Physiology;

Acting Assistant Dean of Admissions;

B.A. Oklahoma City University,

Ph.D. University of Oklahoma College
of Medicine

Sisler, Gary L., D.O.

Assistant Professor, Pathology;

B.S. University of Toledo,

D.O. University of Health Sciences

Slocum, Philip Carroll, D.O.

Associate Professor, Medicine

B.S. Northeast Missouri State University

D.O. Kirksville College of Osteopathic
Medicine

Smith, Gregory Dean, D.O.

Assistant Professor, General and Family
Practice;

B.S. Baylor University,

D.O. Texas College of Osteopathic
Medicine

Spellman, Craig W., Ph.D.

Research Assistant Professor, Microbiology
and Immunology;

B.S. University of Washington,

M.S. Montana State University,

Ph.D. University of Utah

Srinivasan, N. G., Ph.D.

Research Professor, Biochemistry;

B.S. and M.S. University of Madras,

Ph.D. Tufts University

Steenkamp, Johannes C., H.D., D.O.,

M.P.H., F.A.O.C.P.M.

Associate Professor, Public Health and
Preventive Medicine (Public Health and
Community Medicine);

Director, Public Health and Community
Medicine;

H.D. Lindlahr College,

M.P.H. University of Texas Health Science
Center at Houston,

D.O. Chicago College of Osteopathic
Medicine

Stern, Paul A., D.O., F.A.O.C.A.

Professor and Chairman, Anesthesiology;

Associate Dean, Specialty Medicine;

B.S. Wayne State University,

D.O. University of Health Sciences

Stern, Stephen, D.O., F.A.O.C.A.

Associate Professor, Anesthesiology;

D.O. University of Osteopathic Medicine
and Health Sciences

Taylor, Scott C., D.O.

Associate Professor, Public Health and
Preventive Medicine (Health and Human
Fitness);

B.S. University of Texas at Arlington

D.O. University of Health Sciences

Tepper, Fred, D.O.

Associate Professor, Public Health and Preventive Medicine (Rehabilitation/Sports Medicine);
Director, Rehabilitation/Sports Medicine Division;

B.A. Maryville College,
D.O. Kirksville College of Osteopathic Medicine

Trinkle, Patrick L., D.O.

Assistant Professor, Medicine;
B.A. University of Texas at Arlington,
D.O. University of Health Sciences

Troutman, Monte, D.O.

Associate Professor, Medicine;
B.S. Bowling Green State University,
D.O. Chicago College of Osteopathic Medicine

Tyler, James R., D.O.

Associate Professor, Surgery;
B.A. University of Buffalo,
D.O. Philadelphia College of Osteopathic Medicine

Urban, Stephen F., D.O., F.A.C.G.P.

Professor, General and Family Practice;
B.S. University of Buffalo,
D.O. Kirksville College of Osteopathic Medicine

Vick, David A., D.O.

Assistant Professor, Manipulative Medicine;
B.S. Northeast Missouri State University,
D.O. University of Health Sciences

Walker, Tero J., D.O.

Assistant Professor, Surgery;
B.S. Northwestern State University,
D.O. University of Health Sciences

Weis, Stephen E., D.O.

Assistant Professor, Medicine
B.S. Iowa State University,
D.O. University of Osteopathic Medicine and Health Sciences

Weiss, Stanley, D.O.

Associate Professor, Public Health and Preventive Medicine (Health and Human Fitness);
Director, Health and Human Fitness Division;
D.O. Chicago College of Osteopathic Medicine

Whiting, Craig D., D.O.

Assistant Professor, General and Family Practice;
B.S. Texas A and I University,
D.O. Texas College of Osteopathic Medicine

Wilkins, Frederick M., D.O., F.A.O.C.R.
Professor and Chairman, Radiology;
B.S. Elizabethtown College,
D.O. Philadelphia College of Osteopathic Medicine

Wilson, Judy R., Ph.D.

Instructor, Physiology;
B.S. Pacific Union College,
M.S. California Polytechnical University,
Ph.D. Kent State University

Wilson, Winter B., D.O.

Assistant Professor, Medicine;
B.S. Belhaven College,
D.O. West Virginia College of Osteopathic Medicine

Wimbish, Gary H., Ph.D.

Associate Professor, Pathology;
B.S. Texas A&M University,
Ph.D. Indiana University Medical Center

Wise, Gary E., Ph.D.

Professor and Chairman, Anatomy;
B.A. University of Denver,
Ph.D. University of California at Berkeley

Wood, H. Stan, D.O.

Assistant Professor, Medicine;
B.S. East Central State University,
B.S. University of Oklahoma,
D.O. College of Osteopathic Medicine of Oklahoma State University

Woodworth, Robert M., D.O.,

F.A.C.P.M., F.A.A.P., F.A.O.C.P.M.
Associate Professor, Public Health and Preventive Medicine (Health and Human Fitness);

B.S. University of Michigan,
M.P.H. University of Oklahoma,
D.O. Chicago College of Osteopathic Medicine

Wordinger, Robert J., Ph.D.

Associate Professor, Anatomy;
B.S. Pennsylvania State University,
M.S. and Ph.D. Clemson University

Wu, Ming-Chi, Ph.D.

Associate Professor, Biochemistry;
B.S. National Taiwan University,
Ph.D. University of Wisconsin

Yorio, Thomas, Ph.D.

Associate Professor, Pharmacology;
B.A. H.H. Lehman College,
Ph.D. Mt. Sinai School of Medicine

Yüksel, K. Umit, Ph.D.

Research Professor, Biochemistry;
B.S. Middle East Technical University,
M.S. Bosphorus University,
Ph.D. University of North Texas

Zachary, T. Eugene, D.O., F.A.C.G.P.

Associate Professor, General and Family Practice;

Vice President for Academic Affairs and Dean;

B.A. University of North Texas,

D.O. University of Health Sciences

Zanecchia, M. Denise, Ph.D.

Research Associate Professor, Medical Education;

B.S. University of San Francisco,

M.S. California State University at Los Angeles,

Ph.D. University of Connecticut

Zemenick, Richard B., D.O.

Associate Professor, General and Family Practice (Emergency Medicine);

Director, Emergency Medicine Division;

B.S. University of Texas at Arlington,

D.O. Texas College of Osteopathic Medicine

EMERITUS FACULTY

Coy, Marion E., D.O., F.A.C.G.P.

Professor Emeritus, Manipulative Medicine;

B.S. Eureka College,

D.O. Kirksville College of Osteopathic Medicine

Ellis, Virginia P., D.O.

Professor Emeritus, Public Health and Preventive Medicine (Public Health and Community Medicine);

D.O. Kirksville College of Osteopathic Medicine

PROFESSIONAL LIBRARY STAFF

Brooks, Ann

Coordinator, Extramural Services;

Assistant Professor, Medical Education;

B.S. California Polytechnic University,

M.L.S. University of Pittsburgh,

M.B.A. Texas Christian University

Carter, Bobby R.

Director, Library Services;

Associate Professor, Medical Education;

B.S. University of Houston,

M.S. Louisiana State University

Elam, Craig S.

Associate Director, Technical Services;

Assistant Professor, Medical Education;

A.B. Stanford University,

M.L.S. University of California at Berkeley

Martin, Dohn H.

Systems Librarian;

M.S. and M.S.L.S. University of North Carolina, Chapel Hill

Mason, Timothy D.

Technical Services/Cataloging Librarian;

Instructor, Medical Education;

B.A. University of Cincinnati,

M.L.S. University of North Texas

McInroy-Hocevar, Moira

Learning Resource Center Librarian;

Assistant Professor, Medical Education;

B.Ed. Nottingham University,

M.A. Glasgow University,

M.L.S. University of North Texas

Muirhead, Phyllis

Coordinator, Information Services;

Instructor, Medical Education;

B.S. Baylor University,

M.L.S. University of North Texas

Porter, Sherry

Serials Librarian;

Instructor, Medical Education;

B.A. Southwest Texas State University,

M.L.S. University of Texas at Austin

Raymond, Sue

Reference Librarian;

Instructor, Medical Education;

B.A. Georgetown College,

M.L.S. University of Missouri at Columbia

Stokes, Ray

Curator, Special Collections;

B.A. Texas Christian University

Taber, Gay

Reference Librarian;

Instructor, Medical Education;

B.A. University of North Texas,

M.L.S. Texas Woman's University

Wood, Richard

Associate Director, Public Services;

Assistant Professor, Medical Education;

B.A. University of Texas at Arlington,

M.L.S. University of South Carolina

CLINICAL/ADJUNCT FACULTY

Adamo, Michael P., D.O.

Clinical Assistant Professor, Medicine

Alba, Ramon, D.O.

Clinical Associate Professor, General and Family Practice

Albertson, Gary Roger, D.O.

Clinical Associate Professor, General and Family Practice

Alexander, Jerry M., D.O.
Clinical Associate Professor, General and Family Practice

Almy, E. June, D.O.
Clinical Assistant Professor, General and Family Practice

Alvarez-Gonzalez, Rafael, Ph.D.
Adjunct Professor, Biochemistry

Angelo, Christopher S., D.O.
Clinical Associate Professor, General and Family Practice

Ansohn, John R., D.O.
Clinical Instructor, General and Family Practice

Apsley-Ambriz, Sara, D.O.
Clinical Assistant Professor, General and Family Practice

Armbruster, David, D.O.
Clinical Associate Professor, General and Family Practice

Armbruster, Jerome L., D.O.
Clinical Associate Professor, General and Family Practice

Avery, Wilbur G., M.D.
Clinical Professor, Medicine

Ayer, Max E., D.O.
Clinical Associate Professor, General and Family Practice

Baldwin, Kenneth H., D.O.
Clinical Associate Professor, General and Family Practice

Barkman, William R., D.O.
Clinical Associate Professor, General and Family Practice

Bascone, A. G., D.O.
Clinical Associate Professor, Radiology

Beard, Marianne, D.O.
Clinical Instructor, General and Family Practice

Beaty, Barry L., D.O.
Clinical Associate Professor, General and Family Practice

Beckwith, Jay G., D.O.
Clinical Associate Professor, Medicine

Behrens, J. Michael, D.O.
Clinical Associate Professor, General and Family Practice

Behrens, Kenyon R., D.O.
Clinical Assistant Professor, General and Family Practice

Beller, Michael J., M.D.
Clinical Assistant Professor, General and Family Practice

Benderoff, Fred, D.O.

Clinical Associate Professor, General and Family Practice

Bennett, John Scott, D.O.
Clinical Assistant Professor, General and Family Practice

Bernard, Allen S., D.O.
Clinical Associate Professor, General and Family Practice

Bernstein, Donald, D.O.
Clinical Associate Professor, General and Family Practice

Bernstein, Sidney H., D.O.
Clinical Associate Professor, General and Family Practice

Beyer, David M., D.O.
Clinical Assistant Professor, Surgery;
Clinical Associate Professor, General and Family Practice

Beyer, R. B., D.O.
Clinical Associate Professor, Manipulative Medicine

Bigsby, Glenn E., III, D.O.
Clinical Associate Professor, General and Family Practice

Birdwell, Larry R., D.O.
Clinical Assistant Professor, General and Family Practice

Bode, Robert, D.O., F.A.C.C.
Clinical Assistant Professor, Medicine

Bollon, Arthur, D.O.
Adjunct Professor, Biochemistry

Bond, W. Eugene, Jr., D.O.
Clinical Associate Professor, General and Family Practice

Boone, William R., Jr., D.O.
Clinical Assistant Professor, General and Family Practice

Bourdage, Robert J., Ph.D.
Adjunct Assistant Professor, Medical Education

Boyd, John H., D.O.
Clinical Professor, General and Family Practice

Bradley, Frank, D.O.
Clinical Associate Professor, Radiology

Brancel, Dale H., D.O.
Clinical Assistant Professor, Surgery

Brenner, John F., D.O.
Clinical Assistant Professor, Medicine

Brick, Harry, Ph.D.
Clinical Assistant Professor, Psychiatry and Human Behavior

Brien, James, D.O., F.A.A.P.
Clinical Assistant Professor, Pediatrics

Briney, Stanley R., D.O.
Clinical Associate Professor, Radiology

Brooks, Edward M., D.O.
Clinical Associate Professor,
Otorhinolaryngology

Brooks, Sister Anne, D.O.
Clinical Assistant Professor, General and
Family Practice

Bryant, Sullivan Ross, D.O.
Clinical Associate Professor, General and
Family Practice

Buckalew, Edmund Boyd, D.O.
Clinical Associate Professor, General and
Family Practice

Bull, Jarvis, D.O.
Clinical Associate Professor, General and
Family Practice

Burke, Andrew B., D.O.
Clinical Assistant Professor, General and
Family Practice

Burke, Joseph W., Jr., D.O.
Clinical Associate Professor, General and
Family Practice

Burke, Joseph W., III, D.O.
Clinical Assistant Professor, General and
Family Practice

Burns, Clinton L., D.O.
Clinical Associate Professor, General and
Family Practice

Burrows, Larry, D.O.
Clinical Associate Professor, General and
Family Practice

Calabrese, Glenn M., D.O.
Clinical Assistant Professor, General and
Family Practice (Emergency Medicine)

Calabria, James T., D.O., F.A.C.O.S.
Clinical Associate Professor, Surgery

Campanile, Richard J., D.O.
Clinical Associate Professor, General and
Family Practice

Campbell, Gary H., D.O.
Clinical Associate Professor, Public Health
and Preventive Medicine (Public Health
and Community Medicine);
Clinical Associate Professor, General and
Family Practice

Candelaria, Luz A., D.O.
Clinical Associate Professor, General and
Family Practice

Cannon, Gary, D.O.
Clinical Associate Professor, General and
Family Practice

Cantrell, Elroy, D.O.
Clinical Assistant Professor, General and
Family Practice

**Carlton, Catherine Kenney, D.O.,
F.A.A.O.**
Clinical Professor, General and Family
Practice;
Clinical Professor, Manipulative Medicine

Carnicky, Richard B., D.O.
Clinical Associate Professor, General and
Family Practice

Carpenter, Billy T., D.O.
Clinical Associate Professor, General and
Family Practice

Carpenter, Joseph S., D.O.
Clinical Associate Professor, General and
Family Practice

Carter, Richard A., D.O.
Clinical Assistant Professor, Surgery

Carter, Ruth E., D.O.
Clinical Associate Professor, General and
Family Practice

Castoldi, Thomas A., D.O.
Clinical Associate Professor, General and
Family Practice

Cegelski, John J., Jr., D.O., F.A.C.G.P.
Clinical Associate Professor, General and
Family Practice

Chambers, Herbert L., D.O.
Clinical Associate Professor, General and
Family Practice

Childress, Jack R., M.D.
Clinical Assistant Professor, Medicine

Chodosh, Thomas B., D.O.
Clinical Associate Professor, General and
Family Practice

Christiansen, Don E., D.O.
Clinical Associate Professor, General and
Family Practice

Cohen, Jack B., D.O.
Clinical Assistant Professor, Dermatology

Cohen, Phillip, D.O.
Clinical Assistant Professor, Medicine

Coleridge, Samuel T., D.O.
Clinical Associate Professor, General and
Family Practice (Emergency Medicine)

Cook, Charles R., D.O.
Clinical Assistant Professor, General and
Family Practice

Cook, Paul F., Ph.D.
Adjunct Professor, Biochemistry

Cothorn, William F., D.O.
Clinical Assistant Professor, General and
Family Practice

Cox, Virgil M., Jr., M.D.
Clinical Assistant Professor, Psychiatry and
Human Behavior

Crawford, Robert R., D.O.
Clinical Assistant Professor, Surgery

Cudd, William W., III, D.O.
Clinical Assistant Professor, General and Family Practice

Cundarl, Frank, D.O.
Clinical Assistant Professor, Ophthalmology

Cunniff, Nelda, D.O.
Clinical Associate Professor, General and Family Practice

Cunningham, Don G., D.O.
Clinical Associate Professor, General and Family Practice

Curry, Nick U., M.D.
Clinical Assistant Professor, Public Health and Preventive Medicine (Public Health and Community Medicine)

Czewski, James W., D.O.
Clinical Associate Professor, General and Family Practice

Daniels, Egeene Q., D.V.M.
Adjunct Assistant Professor, Microbiology and Immunology

Daniels, Ronald L., D.O.
Clinical Associate Professor, General and Family Practice

Darby, Richard, D.O.
Clinical Associate Professor, General and Family Practice

Davis, Alyson C., D.O.
Clinical Assistant Professor, General and Family Practice

Davis, B. J., D.O.
Clinical Associate Professor, General and Family Practice

Davis, Don D., D.O.
Clinical Associate Professor, General and Family Practice

Davis, Jerry T., D.O.
Clinical Assistant Professor, General and Family Practice

Davis, M. McKim, D.O.
Clinical Associate Professor, General and Family Practice

Davis, Stephen J., D.O.
Clinical Associate Professor, General and Family Practice

Dayton, Martin, D.O.
Clinical Associate Professor, General and Family Practice

De Lia, Frank A., D.O.
Clinical Associate Professor, General and Family Practice

De Luca, Robert Charles, D.O.
Clinical Assistant Professor, General and Family Practice

De Santis, Louis, Ph.D.
Adjunct Assistant Professor, Pharmacology

Devenport, Billy C., D.O.
Clinical Assistant Professor, General and Family Practice

Diaz, Jess J., D.O.
Clinical Associate Professor, General and Family Practice

Dobson, Walter, D. O.
Clinical Associate Professor, Surgery

Donahue, Manus, Ph.D.
Adjunct Assistant Professor, Pharmacology

Dott, Raymond, D.O.
Clinical Associate Professor, Radiology

Dowling, J. Gordon, D.O.
Clinical Associate Professor, General and Family Practice

Doyle, Georgia, D.O.
Clinical Associate Professor, General and Family Practice

Earp, Gary, D.O.
Clinical Associate Professor, General and Family Practice

Eliades, Mel, D.O.
Clinical Assistant Professor, General and Family Practice

English, Wayne R., D.O., F.A.O.C.P.M.
Clinical Professor, Public Health and Preventive Medicine (Rehabilitation/Sports Medicine)

Eutzler, James, D.O.
Clinical Associate Professor, General and Family Practice

Everett, Carl E., D.O.
Clinical Professor, General and Family Practice

Faigin, Al, D.O.
Clinical Associate Professor, General and Family Practice

Farrar, V. Jean, D.O.
Clinical Assistant Professor, General and Family Practice

Feingold, Richard J., D.O.
Clinical Assistant Professor, Medicine

Feinstein, Michael J., D.O.
Clinical Associate Professor, General and Family Practice

Firstenberg, Barry A., D.O.
Clinical Assistant Professor, Medicine

Fischer, Roy L., D.O., F.A.C.O.O.G.
Clinical Associate Professor, Obstetrics and Gynecology

Fisher, Roy B., D.O.

Clinical Associate Professor, Surgery

Flaggman, Paul D., D.O.

Clinical Assistant Professor, Medicine

Fling, John A., M.D., F.A.A.P.

Clinical Assistant Professor, Medicine

Franz, Charles M., D.O.

Clinical Assistant Professor, General and Family Practice

Friedman, Richard H., D.O.

Clinical Assistant Professor, Public Health and Preventive Medicine (Rehabilitation/ Sports Medicine)

Furber, Edward D., M.D.

Clinical Assistant Professor, Psychiatry and Human Behavior

Gabier, Wendell V., D.O.

Clinical Associate Professor, Radiology

Galarneau, Howard, Jr., D.O.

Clinical Assistant Professor, General and Family Practice

Galewaler, John E., D.O.

Clinical Associate Professor, General and Family Practice

Galvas, Pat, Ph.D.

Clinical Assistant Professor, Manipulative Medicine

Gan, Mark F., D.O.

Clinical Assistant Professor, General and Family Practice

Ganz, Samuel B., D.O., F.A.C.G.P.

Clinical Associate Professor, General and Family Practice

Garcia, Raymond, M.D.

Clinical Associate Professor, Dermatology

Gardner, Bennett T., D.O.

Clinical Assistant Professor, General and Family Practice

Garmon, Anesia K., D.O.

Clinical Associate Professor, General and Family Practice

Garrison, Olie R., D.O.

Clinical Assistant Professor, General and Family Practice

Gartzman, N. Harry, D.O.

Clinical Associate Professor, General and Family Practice

Glickfeld, Myron, D.O.

Clinical Associate Professor, Surgery

Godell, Chester, Jr., D.O.

Clinical Assistant Professor, Medicine

Goedecke, R. Leroy, D.O.

Clinical Associate Professor, General and Family Practice

Goetz, Dudley W., D.O., F.A.O.C.D.

Clinical Associate Professor, Dermatology

Goldman, Allan P., D.O.

Clinical Associate Professor, General and Family Practice

Gonzalez, Fernando, D.O.

Clinical Assistant Professor, Pediatrics

Good, Robert, D.O.

Clinical Associate Professor, General and Family Practice

Gorman, Brent E., D.O.

Clinical Assistant Professor, General and Family Practice

Grant, Stephen R., Ph.D.

Adjunct Assistant Professor, Microbiology and Immunology

Grayson, Charles W., D.O.

Clinical Assistant Professor, General and Family Practice

Griffin, J. Brad, D.O.

Clinical Assistant Professor, General and Family Practice

Gross, Robert H., M.D.

Clinical Assistant Professor, Psychiatry and Human Behavior

Guevara, Alex, Jr., D.O.

Clinical Instructor, General and Family Practice

Guthrie, Roger, D.O.

Clinical Assistant Professor, Obstetrics and Gynecology

Haberer, Paul, D.O.

Clinical Associate Professor, General and Family Practice

Hairston, William W., D.O.

Clinical Associate Professor, General and Family Practice

Halcomb, William W., D.O.

Clinical Associate Professor, General and Family Practice

Hall, Charles R., D.O.

Clinical Instructor, General and Family Practice

Hall, Richard M., D.O.

Clinical Professor, General and Family Practice

Haman, David, D.O.

Clinical Assistant Professor, General and Family Practice

Hames, Robert B., D.O.

Clinical Associate Professor, General and Family Practice

Hamilton, Robert L., D.O.

Clinical Associate Professor, General and Family Practice

Hawa, James, D.O.
Clinical Associate Professor, General and Family Practice

Hayes, Lloyd G., D.O.
Clinical Associate Professor, General and Family Practice

Hayes, Randall E., D.O.
Clinical Assistant Professor, General and Family Practice

Hayes, Vernon M., D.O., F.A.C.O.G.
Clinical Associate Professor, Obstetrics and Gynecology

Hazellp, Sandra Jo, D.O.
Clinical Assistant Professor, General and Family Practice

Heaver, Mark, D.O.
Clinical Associate Professor, General and Family Practice

Henley, Robert D., D.O.
Clinical Associate Professor, General and Family Practice

Henwood, William R., D.O.
Clinical Assistant Professor, Surgery

Hernandez, Harry, D.O.
Clinical Assistant Professor, General and Family Practice

Herr, Sylvia, D.O.
Clinical Assistant Professor, General and Family Practice

Hey, Wayne, D.O.
Clinical Assistant Professor, Surgery

Hill, Fredrick L., D.O.
Clinical Associate Professor, General and Family Practice

Hinshaw, Walter Duane, D.O.
Clinical Associate Professor, General and Family Practice

Hoffman, Michael D., D.O.
Clinical Associate Professor, General and Family Practice

Holston, Robert G., D.O.
Clinical Associate Professor, General and Family Practice

Holton, Mark, D.O.
Clinical Assistant Professor, Pediatrics

Hooper, C. Dan
Adjunct Instructor, Pharmacology

Hosler, James, M.D.
Clinical Associate Professor, Medicine

Howell, Shelly H., D.O.
Clinical Associate Professor, General and Family Practice

Hubner, Richard, D.O.
Clinical Instructor, General and Family Practice

Hudson, Richard C., D.O.
Clinical Assistant Professor, Surgery

Hughes, Mark D., D.O.
Clinical Associate Professor, General and Family Practice

Hull, Christopher K., D.O.
Clinical Assistant Professor, Surgery

Hulse, Alfred T., D.O.
Clinical Assistant Professor, General and Family Practice

Hussey, Jim P., D.O.
Clinical Associate Professor, General and Family Practice

Ingraham, Daniel, D.O.
Clinical Assistant Professor, Dermatology

Isbell, Phillip D., D.O.
Clinical Assistant Professor, General and Family Practice

Jacobson, Elaine, Ph.D.
Adjunct Professor, Biochemistry

Johnson, E. Arnold, D.O.
Clinical Assistant Professor, General and Family Practice

Johnson, E. R., D.O.
Clinical Assistant Professor, Medicine

Johnson, Harold E., D.O.
Clinical Assistant Professor, General and Family Practice

Johnson, Jimmy D., D.O.
Clinical Associate Professor, General and Family Practice

Johnson, Wayne, D.O.
Clinical Assistant Professor, Radiology

Jones, Myron, D.O.
Clinical Associate Professor, Medicine

Jordan, William M., D.O.
Clinical Assistant Professor, Medicine

Kebabjian, S. Stevon, D.O., F.A.O.C.A.
Clinical Associate Professor, Anesthesiology

Kellers, Royce K., D.O., F.A.C.G.P.
Clinical Associate Professor, General and Family Practice

Kelley, Jeffrey R., D.O.
Clinical Assistant Professor, General and Family Practice

Kelso, Elmer L., D.O., F.A.O.C.A.
Clinical Associate Professor, Anesthesiology

Kelso, George, D.O.
Clinical Associate Professor, General and Family Practice

Kent, Robert C., D.O.
Clinical Assistant Professor, General and Family Practice

Keyser, Peter D., D.O.

Clinical Assistant Professor, General and Family Practice

Killian, Gary M., D.O.

Clinical Associate Professor, General and Family Practice

Kinzie, Earl C., D.O.

Clinical Professor, General and Family Practice

Kirkdorffer, Duane E., D.O.

Clinical Assistant Professor, General and Family Practice

Kirkwood, M. E., D.O.

Clinical Assistant Professor, General and Family Practice

Kirlin, Patrick J., D.O.

Clinical Associate Professor, General and Family Practice

Kludo, Ronald G., D.O.

Clinical Associate Professor, General and Family Practice

Kmetz, John G., D.O.

Clinical Associate Professor, General and Family Practice

Knight, Brian G., D.O.

Clinical Assistant Professor, General and Family Practice

Konald, George E., D.O.

Clinical Associate Professor, General and Family Practice

Kopman, Norman, D.O.

Clinical Assistant Professor, Medicine

Kow, Avis M., M.D.

Clinical Assistant Professor, General and Family Practice

Kozura, John, III, D.O.

Clinical Associate Professor, General and Family Practice

Kramer, Thomas N., M.D.

Clinical Associate Professor, General and Family Practice

Kravetz, James H., D.O.

Clinical Associate Professor, General and Family Practice

Kristoferson, John, M.D.

Clinical Assistant Professor, Public Health and Preventive Medicine (Rehabilitation/Sports Medicine)

Krupp, Myron, D.P.M.

Clinical Assistant Professor, Public Health and Preventive Medicine (Rehabilitation/Sports Medicine)

Kudelko, David, D.O.

Clinical Associate Professor, General and Family Practice

Lancaster, Jere R., D.O.

Clinical Associate Professor, Radiology

Leech, Richard C., D.O.

Clinical Assistant Professor,

Anesthesiology

Lees, John B., D.O.

Clinical Assistant Professor, General and Family Practice

Levin, Jon I., D.O.

Clinical Assistant Professor, Surgery

Levine, Kenneth M., D.O.

Clinical Associate Professor, General and Family Practice

Levy, Neil S., D.O.

Clinical Assistant Professor, Pediatrics

Lewey, Scott M., D.O.

Clinical Assistant Professor, General and Family Practice

Lewis, Harold D., D.O.

Clinical Associate Professor, General and Family Practice

Liedtke, Curtis J., D.O.

Clinical Associate Professor, General and Family Practice

Lindsey, George C., D.O.

Clinical Associate Professor, General and Family Practice

Ling, Robert R., D.O.

Clinical Associate Professor, General and Family Practice

Linton, James W., D.O.

Clinical Associate Professor, General and Family Practice

Lively, James, D.O.

Clinical Associate Professor, Radiology

Livingston, R. Paul, D.O.

Clinical Associate Professor, General and Family Practice

Lizerbram, Sol, D.O.

Clinical Associate Professor, General and Family Practice

Locke, John B., D.O.

Clinical Associate Professor, Medicine

Lopez, Hector, D.O.

Clinical Assistant Professor, General and Family Practice

Lorenz, Constance, D.O.

Clinical Instructor, General and Family Practice

Lowry, J. Roy, D.O.

Clinical Assistant Professor, Otorhinolaryngology

Lulbel, George J., D.O.

Clinical Professor, General and Family Practice

Lund, Gregg C., D.O.
Clinical Assistant Professor, Pediatrics;
Clinical Assistant Professor, Physiology

Magie, Richard, D.O.
Clinical Assistant Professor, Pediatrics

Mahoney, James J., D.O.
Clinical Assistant Professor, General and
Family Practice

Manos, Andrew J., D.O.
Clinical Associate Professor, General and
Family Practice

Martin, James R., D.O.
Clinical Assistant Professor, General and
Family Practice

Martin, Linda J., D.O.
Clinical Associate Professor, General and
Family Practice

Martin, Luther C., D.O.
Clinical Associate Professor, General and
Family Practice

Martz, Russell, D.O.
Clinical Associate Professor, Surgery

**Matthews, James G., Jr., D.O.,
F.A.C.C.O.G.**
Clinical Professor, Obstetrics and
Gynecology

Maul, R. Greg, D.O.
Clinical Associate Professor, General and
Family Practice

Maul, Robert G., D.O.
Clinical Associate Professor, General and
Family Practice

Maxwell, Jack A., D.O.
Clinical Assistant Professor, General and
Family Practice

Mayer, Richard M., D.O.
Clinical Associate Professor, General and
Family Practice

Maynard, Daniel A., D.O.
Clinical Associate Professor, General and
Family Practice

McCarty, F. Timm, D.O.
Clinical Associate Professor, General and
Family Practice

McCarty, William, D.O.
Clinical Assistant Professor, Surgery

McCorckle, Brandt H., D.O.
Clinical Associate Professor, General and
Family Practice

McKenney, Carl K., D.O.
Clinical Associate Professor, General and
Family Practice

McKinney, Mark E., Ph.D.
Clinical Associate Professor, Psychiatry
and Human Behavior

McLaughlin, James A., D.O.
Clinical Associate Professor, General and
Family Practice

McLeod, Kenneth D., D.O.
Clinical Associate Professor, General and
Family Practice

McQueen, Gregory P.
Adjunct Instructor, Medical Education

Medina, Francisco, D.O.
Clinical Associate Professor, General and
Family Practice

Meltzer, Victor N., M.D.
Clinical Associate Professor, Medicine

Merrill, James M., D.O.
Clinical Associate Professor, General and
Family Practice

Merwin, Ralph C., D.O.
Clinical Associate Professor, General and
Family Practice

Meyerson, Larry, Ph.D.
Adjunct Associate Professor, Pharmacol-
ogy

Miers, John, D.O., F.A.C.C.O.G.
Clinical Assistant Professor, Obstetrics and
Gynecology

Millionis, John W., D.O., F.A.C.C.O.P.
Clinical Assistant Professor, Pediatrics

Miller, Thomas, D.O.
Clinical Associate Professor, General and
Family Practice

Millington, Wilfred G., D.O.
Clinical Associate Professor, General and
Family Practice

Mills, Jeffrey A., D.O.
Clinical Assistant Professor, Medicine

Mims, Roy D., Jr., D.O.
Clinical Associate Professor, General and
Family Practice

Montgomery-Davis, Joseph, D.O.
Clinical Associate Professor, General and
Family Practice

Morgan, Frederick D., D.O.
Clinical Associate Professor, General and
Family Practice

Morgan, Samuel S., D.O.
Clinical Associate Professor, General and
Family Practice

Murchison, Ira O., D.O.
Clinical Assistant Professor, General and
Family Practice

Natkow, Neil A., D.O.
Clinical Associate Professor, General and
Family Practice

Nelson, Craig, D.O.
Clinical Assistant Professor, General and

Family Practice
Nelson, Robert L., D.O.
 Clinical Associate Professor, Radiology
Nichols, Richard E., D.O.
 Clinical Associate Professor, General and Family Practice
Nobles, Robert H., D.O.
 Clinical Professor, General and Family Practice
Nolen, Bill D., D.O.
 Clinical Associate Professor, General and Family Practice
Nophsker, Theodore R., Ph.D.
 Clinical Assistant Professor, Medicine
Norris, David F., D.O.
 Clinical Associate Professor, General and Family Practice
Noss, Michael R., D.O.
 Clinical Instructor, General and Family Practice
Nunneley, Robert L., D.O.
 Clinical Associate Professor, General and Family Practice
Nwanyanwu, Okey C., Ph.D.
 Clinical Assistant Professor, Public Health and Preventive Medicine (Public Health and Community Medicine)
O'Connor, Harriette L., D.O.
 Clinical Assistant Professor, General and Family Practice
Olson, Richard M., D.O.
 Clinical Associate Professor, General and Family Practice
Ostrom, Floyd, D.O.
 Clinical Assistant Professor, Pediatrics
Padget, Larry, D.O.
 Clinical Associate Professor, General and Family Practice
Palmer, Wesley D., D.O.
 Clinical Assistant Professor, General and Family Practice
Parvin, Terry L., D.O.
 Clinical Associate Professor, General and Family Practice
Pearson, Harris F., Jr., D.O.
 Clinical Associate Professor, Radiology
Pearson, Phillip E., D.O.
 Clinical Assistant Professor, General and Family Practice
Peden, Richard L., D.O.
 Clinical Associate Professor, General and Family Practice
Pennock, John C., M.D.
 Clinical Assistant Professor, General and Family Practice
Peska, Don N., D.O.
 Clinical Assistant Professor, Surgery
Pettit, James C., D.O.
 Clinical Assistant Professor, General and Family Practice
Petty, Frederick, Ph.D., M.D.
 Adjunct Associate Professor, Pharmacology
Peyton, Dean, D.O.
 Clinical Associate Professor, General and Family Practice
Phillips, Earnest L., Jr., D.O.
 Clinical Associate Professor, General and Family Practice
Phipps, Joe A., D.O.
 Clinical Associate Professor, General and Family Practice
Pifer, Kathryn Bailey, D.O.
 Clinical Assistant Professor, General and Family Practice
Pincus, Lewis M., D.O.
 Clinical Assistant Professor, Medicine
Pipes, George A., D.O.
 Clinical Associate Professor, General and Family Practice
Plattner, Herman H., D.O.
 Clinical Associate Professor, General and Family Practice
Podolsky, Michael, D.O.
 Clinical Associate Professor, Radiology
Poetz, Robert Paul, D.O.
 Clinical Associate Professor, General and Family Practice
Polance, Harold, D.O.
 Clinical Associate Professor, General and Family Practice
Polasky, Hartley, D.O.
 Clinical Associate Professor, General and Family Practice
Polk, Gary L., D.O.
 Clinical Assistant Professor, General and Family Practice
Pope, Ross E., D.O.
 Clinical Assistant Professor, General and Family Practice
Porter, Joe Bob, D.O.
 Clinical Associate Professor, General and Family Practice
Post, Yvonne C., D.O.
 Clinical Assistant Professor, General and Family Practice
Powell, Lynn, D.O.
 Clinical Assistant Professor, Surgery
Pressley, Walter A., Jr., D.O.
 Clinical Associate Professor, General and Family Practice

- Sandknop, Les T., D.O.**
Clinical Associate Professor, General and Family Practice
- Sandlin, Wyman P., D.O.**
Clinical Associate Professor, General and Family Practice
- Santa-Cruz, Frank R., M.D.**
Clinical Assistant Professor, Radiology
- Saperstein, Phillip P., D.O.**
Clinical Professor, General and Family Practice
- Sawtelle, John L., D.O.**
Clinical Assistant Professor, General and Family Practice
- Saylak, Daniel W., D.O.**
Clinical Assistant Professor, General and Family Practice
- Scadron, Hubert M., D.O.**
Clinical Associate Professor, Ophthalmology
- Schafer, Rollie R., Jr., Ph.D.**
Adjunct Associate Professor, Pharmacology
- Schellin, Richard A., D.O.**
Clinical Assistant Professor, Radiology
- Schildberg, Warren L., D.O.**
Clinical Associate Professor, General and Family Practice
- Schmidt, John C., D.O.**
Clinical Assistant Professor, General and Family Practice
- Schneider, Horace Lee, D.O.**
Clinical Assistant Professor, Medicine
- Schuricht, Wayne E., D.O.**
Clinical Assistant Professor, General and Family Practice (Emergency Medicine)
- Schwartz, John P., D.O.**
Clinical Assistant Professor, General and Family Practice
- Scott, Courtney D., Jr., D.O.**
Clinical Associate Professor, General and Family Practice
- Sears, Kristin, D.O.**
Clinical Assistant Professor, Anesthesiology
- Sessions, John L., D.O.**
Clinical Associate Professor, General and Family Practice
- Sharp, Larry J., D.O.**
Clinical Assistant Professor, General and Family Practice
- Sharp, T. Robert, D.O., F.A.C.G.P.**
Clinical Professor, General and Family Practice
- Shauf, Leslie R., D.O.**
Clinical Associate Professor, General and Family Practice
- Shields, Robert F., D.O.**
Clinical Associate Professor, General and Family Practice
- Shields, Robert J., D.O.**
Clinical Associate Professor, General and Family Practice
- Shook, Ross T., D.O.**
Clinical Associate Professor, General and Family Practice
- Sikorski, Eugene L., D.O.**
Clinical Associate Professor, General and Family Practice
- Simonak, David W., D.O.**
Clinical Assistant Professor, General and Family Practice
- Sims, James L., Ph.D.**
Adjunct Assistant Professor, Medical Education
- Skiba, Mary Ann, D.O.**
Clinical Assistant Professor, Medicine
- Skotnik, Tracey M., D.O.**
Clinical Assistant Professor, General and Family Practice
- Slaughter, Paul M., D.O.**
Clinical Associate Professor, General and Family Practice
- Smith, Britt D., M.D.**
Clinical Assistant Professor, General and Family Practice
- Smith, Edward, D.O.**
Clinical Assistant Professor, Surgery
- Smith, George N., D.O.**
Clinical Associate Professor, General and Family Practice
- Smith, James N., D.O.**
Clinical Associate Professor, General and Family Practice
- Smith, Robert E., Sr., D.O.**
Clinical Associate Professor, General and Family Practice
- Smola, Jerome E., D.O.**
Clinical Associate Professor, General and Family Practice
- Sowers, Jerry R., D.O.**
Clinical Associate Professor, General and Clinical Instructor, Anesthesiology
- Squires, William G., Ph.D.**
Adjunct Associate Professor, Physiology
- Steingard, Paul M., D.O.**
Clinical Associate Professor, General and Family Practice
- Stevens, W. Craig, D.O.**
Clinical Associate Professor, General and Family Practice

Probst, R. Mark, D.O.
Clinical Assistant Professor, General and Family Practice

Pruzzo, Neil, D.O.
Clinical Associate Professor, General and Family Practice

Puempel, Otto, D.O.
Clinical Associate Professor, General and Family Practice

Puryear, Billy H., D.O.
Clinical Associate Professor, General and Family Practice

Quatro, Fred, D.O.
Clinical Assistant Professor, Surgery

Quigley, James, D.O.
Clinical Associate Professor, General and Family Practice

Rader, Daniel L., D.O.
Clinical Associate Professor, General and Family Practice

Randolph, Harvey H., D.O., F.A.C.G.P.
Clinical Associate Professor, General and Family Practice

Ranelle, Brian, D.O.
Clinical Associate Professor, Ophthalmology

Ranelle, H. William, D.O.
Clinical Professor, Ophthalmology

Ravin, Sheldon J., D.O.
Clinical Associate Professor, General and Family Practice

Ray, John, D.O.
Clinical Assistant Professor, General and Family Practice (Emergency Medicine)

Redels, S. Lynn, D.O.
Clinical Associate Professor, General and Family Practice

Reese, I. Phillip, D.O.
Clinical Assistant Professor, Medicine

Reeves, Ebb W., D.O.
Clinical Associate Professor, General and Family Practice

Reich, Walter G., Jr., D.O.
Clinical Associate Professor, General and Family Practice

Reis, Penelope A., D.O.
Clinical Assistant Professor, General and Family Practice

Renna, Christian J., D.O.
Clinical Associate Professor, General and Family Practice

Reznick, James W., D.O.
Clinical Assistant Professor, Medicine

Rhodes, Roy L., D.O.
Clinical Associate Professor, General and Family Practice

Rice, Emmett Lee, D.O.
Clinical Associate Professor, General and Family Practice

Rice, Jack W., D.O.
Clinical Associate Professor, General and Family Practice

Rice, Laura L., D.O.
Clinical Assistant Professor, General and Family Practice

Ridenour, Chet D., D.O.
Clinical Assistant Professor, General and Family Practice

Roach, Terry M., D.O.
Clinical Instructor, General and Family Practice

Rocha, Carlos F. D.O.
Clinical Associate Professor, General and Family Practice

Rodgers, Randall W., D.O.
Clinical Assistant Professor, General and Family Practice

Roehr, Esther M., D.O.
Clinical Associate Professor, General and Family Practice

Rogers, William R., D.O.
Clinical Associate Professor, General and Family Practice

Rollins, Kari L., D.O.
Clinical Associate Professor, General and Family Practice

Rollins, Ray E., D.O.
Clinical Assistant Professor, General and Family Practice

Romeo, Tony, Ph.D.
Adjunct Professor, Biochemistry

Ross, Donald M., D.O.
Clinical Assistant Professor, Surgery

Rouch, Daniel R., D.O.
Clinical Assistant Professor, General and Family Practice

Russell, J. Michael, D.O.
Clinical Associate Professor, General and Family Practice

Sabeter, Gilberto M., M.D.
Clinical Assistant Professor, Surgery

Samano, Gregory P., D.O.
Clinical Associate Professor, General and Family Practice

Samuels, Michael G., D.O.
Clinical Associate Professor, General and Family Practice;
Clinical Instructor, Manipulative Medicine

Stevens, Wesley J., D.O.
Clinical Associate Professor, General and Family Practice

Stockburger, Robert, D.O.
Clinical Assistant Professor, Obstetrics and Gynecology

Stokes, John H., D.S.W.
Clinical Assistant Professor, General and Family Practice

Stone, David, D.O.
Clinical Assistant Professor, Surgery

Stoner, Mary F., M.D.
Clinical Instructor, Dermatology

Strazynski, Josef, D.O.
Clinical Assistant Professor, General and Family Practice

Styduhar, Edward A., Jr., D.O.
Clinical Associate Professor, General and Family Practice

Sufian, David, D.O.
Clinical Assistant Professor, Surgery

Swords, Frank, D.O.
Clinical Assistant Professor, Surgery

Tacka, Francis, D.O.
Clinical Associate Professor, Medicine

Teitelbaum, David, D.O.
Clinical Assistant Professor, General and Family Practice;
Clinical Instructor, Manipulative Medicine

Theroux, Marc A., M.D.
Clinical Assistant Professor, Medicine

Thomas, John L., D.O.
Clinical Associate Professor, General and Family Practice

Thompson, Jeffrey C., D.O.
Clinical Associate Professor, General and Family Practice

Thompson, John Paul, D.O.
Clinical Associate Professor, General and Family Practice

Thoreson, Robert R., D.O.
Clinical Assistant Professor, General and Family Practice

Thornton, Martin E., D.O.
Clinical Assistant Professor, General and Family Practice

Tisdale, C. Duane, D.O.
Clinical Associate Professor, General and Family Practice

Trese, Thomas J., D.O.
Clinical Assistant Professor, Medicine

Truman, Michael E., D.O.
Clinical Associate Professor, General and Family Practice

Tuinstra, T. J., D.O.
Clinical Assistant Professor, Surgery

Turner, Thomas R., D.O.
Clinical Associate Professor, Surgery

Umstattd, William R., D.O.
Clinical Associate Professor, General and Family Practice

Ungerleider, Barry I., D.O.
Clinical Associate Professor, General and Family Practice

Van De Grift, William, D.O., F.O.C.O.O.
Clinical Associate Professor,
Ophthalmology;
Clinical Associate Professor,
Otorhinolaryngology

Vasile, Salvatore R., D.O.
Clinical Associate Professor, General and Family Practice

Velasco-Segarra, Luis A., M.D.
Clinical Assistant Professor, General and Family Practice

Ventling, Wayne L., II, D.O.
Clinical Assistant Professor, Radiology

Villegas, Leopold, Jr., D.O.
Clinical Associate Professor, General and Family Practice

Vinson, Steve, D.O.
Clinical Assistant Professor, General and Family Practice (Emergency Medicine)

Waddell, Daniel A., D.O.
Clinical Associate Professor, Medicine

Wakim, Paul E., D.O.
Clinical Associate Professor, Surgery

Walkenhorst, Donald C., D.O.
Clinical Assistant Professor, General and Family Practice

Walker, Janet M., M.D.
Clinical Assistant Professor, General and Family Practice

Wallace, Arnold D., D.O.
Clinical Instructor, Anesthesiology

Wallace, William E., D.O.
Clinical Assistant Professor, Surgery

Walton, John A., D.O.
Clinical Associate Professor, General and Family Practice

Ward, Gordon P., D.O.
Clinical Associate Professor, General and Family Practice

Watkins, Kenneth R., D.O.
Clinical Associate Professor, General and Family Practice

Watson, Terry R., D.O.
Clinical Associate Professor, General and Family Practice

Way, Bill V., D.O.

Clinical Assistant Professor, Dermatology

Weldon, Kent, D.O.

Clinical Assistant Professor, Surgery

Wershaw, Arthur S., D.O.

Clinical Associate Professor, General and Family Practice

White, C. Catherine, D.O.

Clinical Assistant Professor, General and Family Practice (Emergency Medicine)

Whitham, John, D.O.

Clinical Associate Professor, General and Family Practice

Whiting, Craig D., D.O.

Clinical Associate Professor, General and Family Practice

Wilkes, David S., M.D.

Clinical Assistant Professor, Medicine

Willard, Ralph L., D.O., F.A.C.O.S.

Clinical Professor, Surgery

Wilson, Charles T., D.O.,

Clinical Assistant Professor, Surgery

Wilson, John W., D.O.

Clinical Associate Professor, Medicine

Wilson, Joseph E., Ph.D.

Adjunct Professor, Physiology

Winslow, J. Robert, D.O.

Clinical Associate Professor, General and Family Practice

Wiseman, Rodney M., D.O.

Clinical Assistant Professor, General and Family Practice

Wolf, Gary D., D.O.

Clinical Associate Professor, General and Family Practice

Wolpmann, Joseph E., D.O.

Clinical Associate Professor, General and Family Practice

Worrell, Paul Stephen, D.O.

Clinical Assistant Professor, General and Family Practice

Wray, John A., D.O.

Clinical Assistant Professor, General and Family Practice

Wright, Gary G., D.O.

Clinical Associate Professor, General and Family Practice

Wright, James B., D.O.

Clinical Associate Professor, General and Family Practice

Wright, John L., Jr., D.O.

Clinical Associate Professor, General and Family Practice

Wright, Richard C., D.O.

Clinical Associate Professor, General and Family Practice

Young, Andrew R., D.O., F.A.C.G.P.

Clinical Associate Professor, General and Family Practice

Young, George C.

Adjunct Instructor, Public Health and Preventive Medicine (Rehabilitation/Sports Medicine)

Young, Michael R., D.O.

Clinical Assistant Professor, General and Family Practice

Zegarelli, Louis D., D.O.

Clinical Assistant Professor, General and Family Practice

Zini, James E., D.O.

Clinical Associate Professor, General and Family Practice

INDEX

Academic		Emergency Medicine,	
standing.....	30	Division of.....	44
advisement	63	Environments, special.....	26
honors	32	Evaluation and	
probation	32	Information Systems.....	13
programs, special.....	30	Events, Scheduling.....	65
Administrative		Examinations	
officers.....	4	Final.....	31
staff.....	5	Physical.....	19
Admission		Senior.....	31
procedures.....	18	Expenses.....	20
requirements.....	17		
Advanced placement.....	30	Facilities.....	9
Advisory Council,		Faculty.....	67
TCOM.....	5	clinical/adjunct.....	75
Anatomy,		emeritus.....	75
Department of.....	40	Fees.....	20
Anesthesiology,		Financial assistance.....	22
Department of.....	41	Fiscal policies.....	19
residency.....	59	Food service.....	64
Animals,		Foreign students.....	21
use in teaching.....	38		
Attendance.....	26	General and Family	
Auditing.....	30	Practice,	
Awards, Honors.....	65	Department of	
		clinics.....	42
Basic Health Sciences,		residency.....	10
Master of Science in..	58	Grades.....	60
Biochemistry,		incomplete.....	29
Department of.....	42	numerical course.....	28
Biomedical		remedied.....	29
communications.....	13	semester.....	29
Board of Regents,		Graduate degree	
UNT/TCOM.....	4	program.....	58
Calendar.....	7	Graduation,	
Center for Osteopathic		Requirements for.....	34
Research		Grants.....	22
and Education.....	14	Growth of college	9
Clinics.....	10	Guidance, counseling and	
College Work-Study.....	22	academic advisement	63
Continuing medical			
education.....	13	Health and Human	
Counseling.....	63	Fitness, Division of....	53
Course/instructor		Health insurance.....	20
evaluation.....	29	services.....	64
Course of study.....	40	History of the college.....	9
Course syllabus.....	26	Honors, Academic.....	32
Curriculum.....	39	Hospitals, Teaching.....	10
description.....	37	Housing.....	64
development.....	38		
		ID cards.....	64
Dermatology,		Instruction, Program of....	38
Department of.....	42	Institute of Forensic	
Dismissal.....	34	Medicine.....	51
Doctor of Philosophy.....	59	Interdisciplinary studies....	56

Leaves.....	33	Department of.....	32
Library.....	12	Public Health and	
Library staff, professional	75	Community	
Loan programs.....	22	Medicine,	
Location of college.....	10	Division of.....	53
		Public Health and	
Manipulative Medicine,		Preventive	
Department of.....	45	Medicine,	
predoctoral teaching		Department of.....	53
fellowship.....	46		
Master of Science in		Radiology,	
Basic Health Sciences	58	Department of.....	53
MCAT.....	17	Records.....	54
Medical Education,		accessibility of.....	27
Office of.....	46	Registration.....	27
Medical Humanities,		Rehabilitation/Sports	
Department of.....	47	Medicine,	
Medicine,		Division of.....	53
Department of.....	47	Research.....	13
residency.....	60	Residency program in	
Microbiology and		Anesthesiology.....	59
Immunology,		General and Family	
Department of.....	49	Practice.....	60
Military affairs.....	65	Medicine.....	60
Minority students.....	21	Surgery.....	60
Mission of college.....	9	Room, board	
		see Expenses.....	20
National boards.....	31	Scholarships.....	22
Non-resident students.....	21	Scholastic regulations....	25
		Specialty clinics.....	11
Obstetrics and		Staff, Administrative.....	5
Gynecology,		Student Affairs,	
Department of.....	50	Office of.....	63
Officers, Administrative...	4	Student activities.....	64
Ophthalmology,		organizations.....	64
Section of.....	55	Substance Abuse,	
Osteopathic concept.....	1	Division of.....	44
oath.....	2	Support services of	
Otorhinolaryngology,		college.....	11
Section of.....	55	Surgery, Department of..	55
		residency.....	60
Pathology,			
Department of.....	50	Teaching hospitals.....	10
Pediatrics,		Transcripts.....	27
Department of.....	51	Transfer,	
Pharmacology,		Procedures for.....	21
Department of.....	52	Tuition.....	19
Physiology,		refund policy.....	20
Department of.....	52		
Post-graduate programs....		Veterans benefits.....	65
Probation, Academic.....	59	Withdrawal.....	33
Promotion, Academic.....	32		
Psychiatry and Human			
Behavior,			

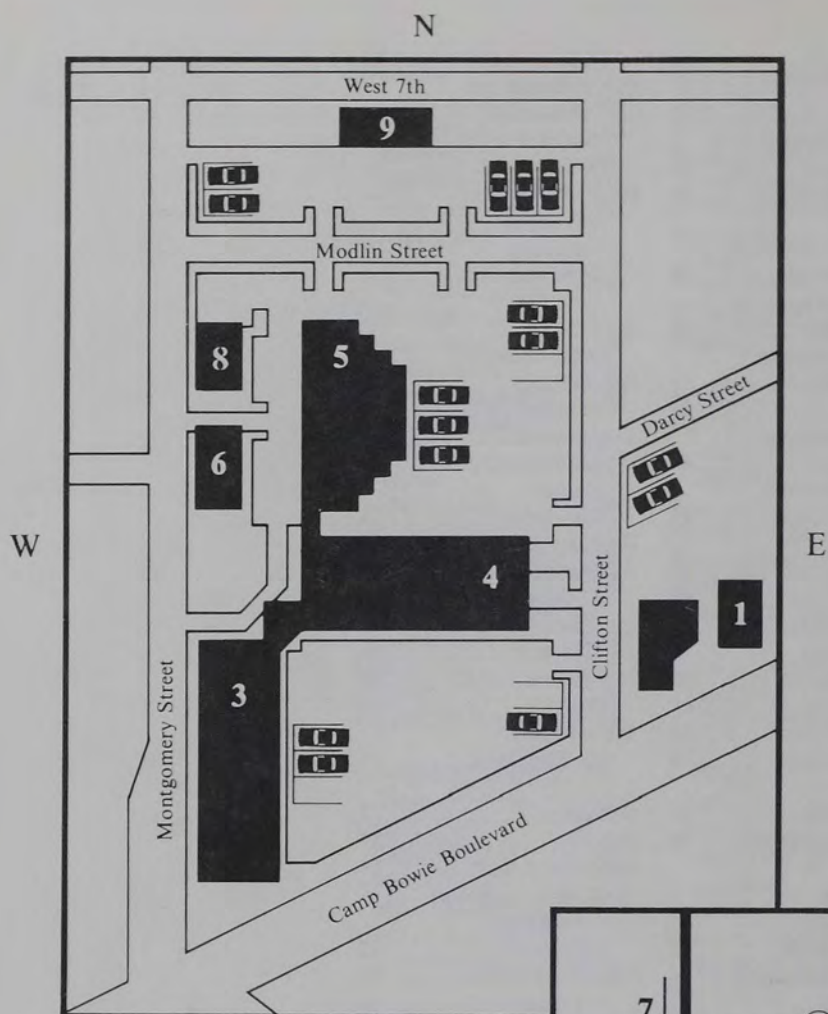

**TCOM CAMPUS
ACCESS MAP**

- 1 Campus Police
- 2 Downtown Fort Worth
- 3 Medical Education Building 1
- 4 Medical Education Building 2
- 5 Medical Education Building 3
- 6 Medicine Clinic
- 7 TCOM
- 8 Surgical Associates
- 9 Activities Center

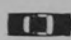

 Parking

**TEXAS COLLEGE OF
OSTEOPATHIC MEDICINE**

Under the direction of the
University of North Texas
Board of Regents

3500 Camp Bowie Boulevard
Fort Worth, Texas 76107-2690
(817) 735-2000

Admissions 1-800-535-TCOM

Rules and regulations in this catalog are effective June 1, 1989, and apply to all students. This catalog is the official catalog for the class of 1993. The provisions of this catalog may be subject to change without notice as a result of official administrative actions in the college, legislative act or decisions by the attorney general of the state of Texas. Information provided by this catalog does not constitute a contract between TCOM and a student or an applicant for admission. The college is not responsible for any misrepresentation or provisions that might arise as a result of errors in preparation of this catalog.

The college may refuse further registration to any student whom the faculty or staff deems incompetent or unfit to continue in the course of study. Students accepted for admission pledge themselves to observe and abide by the existing regulations and standards of conduct of the college as put forth in this catalog published June 1, 1989.

NOTES

NOTES

NOTES



Under the direction of the University of North Texas Board of Regents